

Keep this manual together with the product for future use.
Store it inside, behind the acoustic front panel.

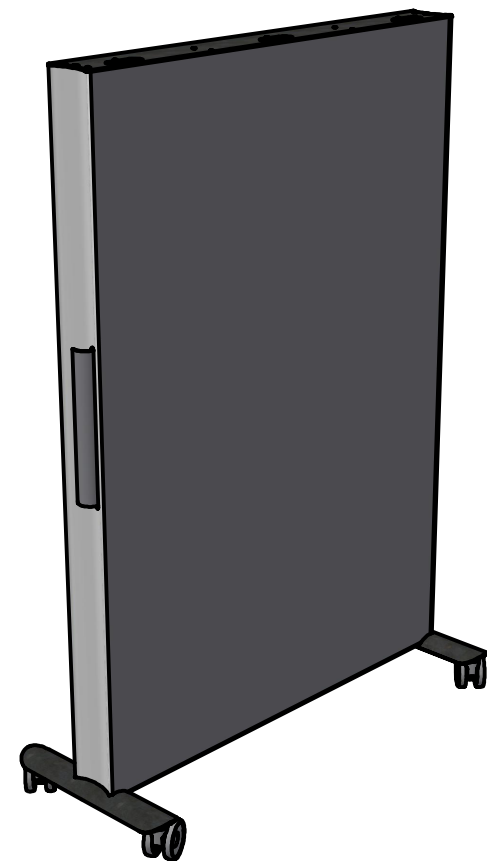

Including components

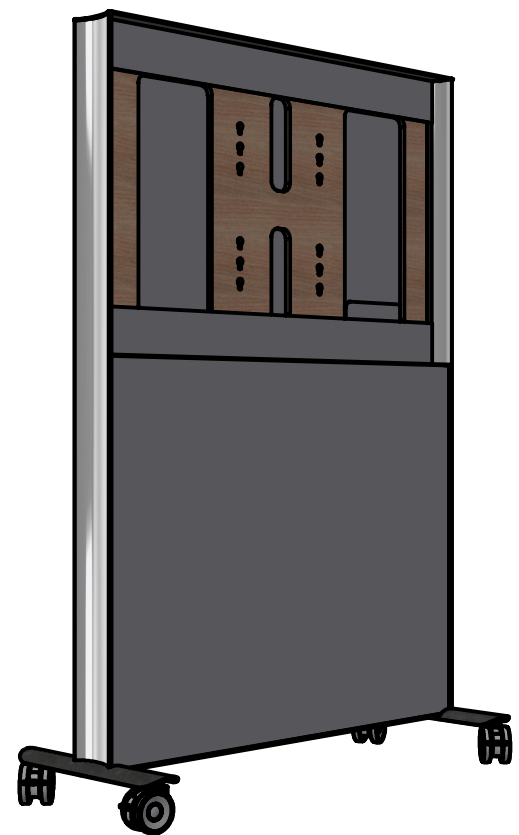
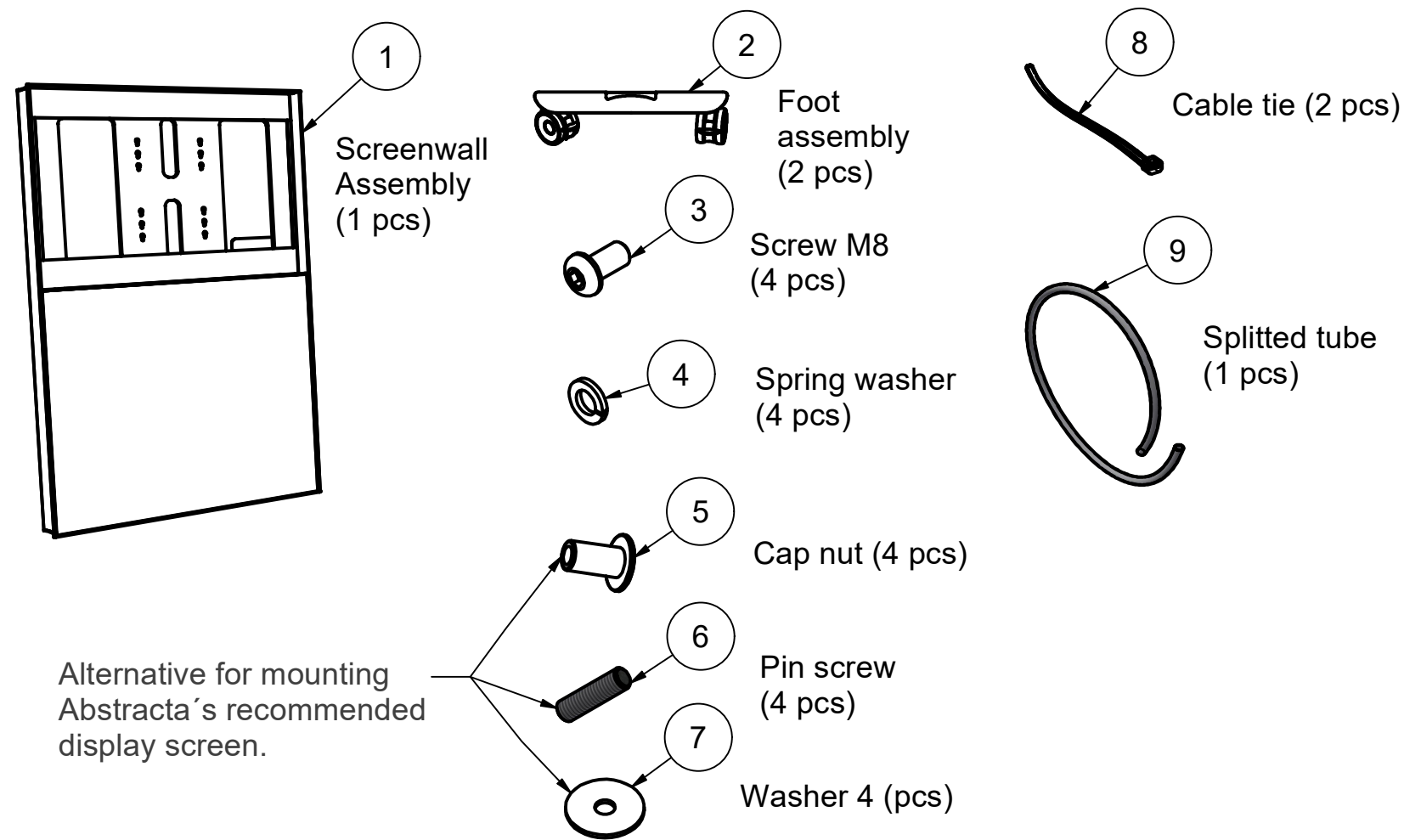

Alternative for mounting
Abstracta's recommended
display screen.

Care instructions

To maintain the color and appearance, the product should be vacuum cleaned regularly with a soft nozzle.

Stain removal: dab or wipe gently with a damp cloth.

Abstracta technical support,
tel.+46472269600.

Mounting the feet and lifting

If possible leave the screen wall on it's pallet while mounting the feet. If not possible, lift it to a table or elevated supportive surface. Be at least 3 persons to perform the heavy lifts during this assembly! In some cases 4 persons is good.

Step 1. Mount the feet using a 5 mm allen key to fasten Screw M8 (3) with Spring washer (4) in between. Tighten the screws so the washers becomes compressed and then another 1/8 turn.

Step 2. Carefully lift the screen wall onto some books or a carpet or similar on the floor.

Step 3. lock one lower wheel and raise the wall to it's wheels. It is good to have persons that can keep this heavy product in balance during the lift and raise.

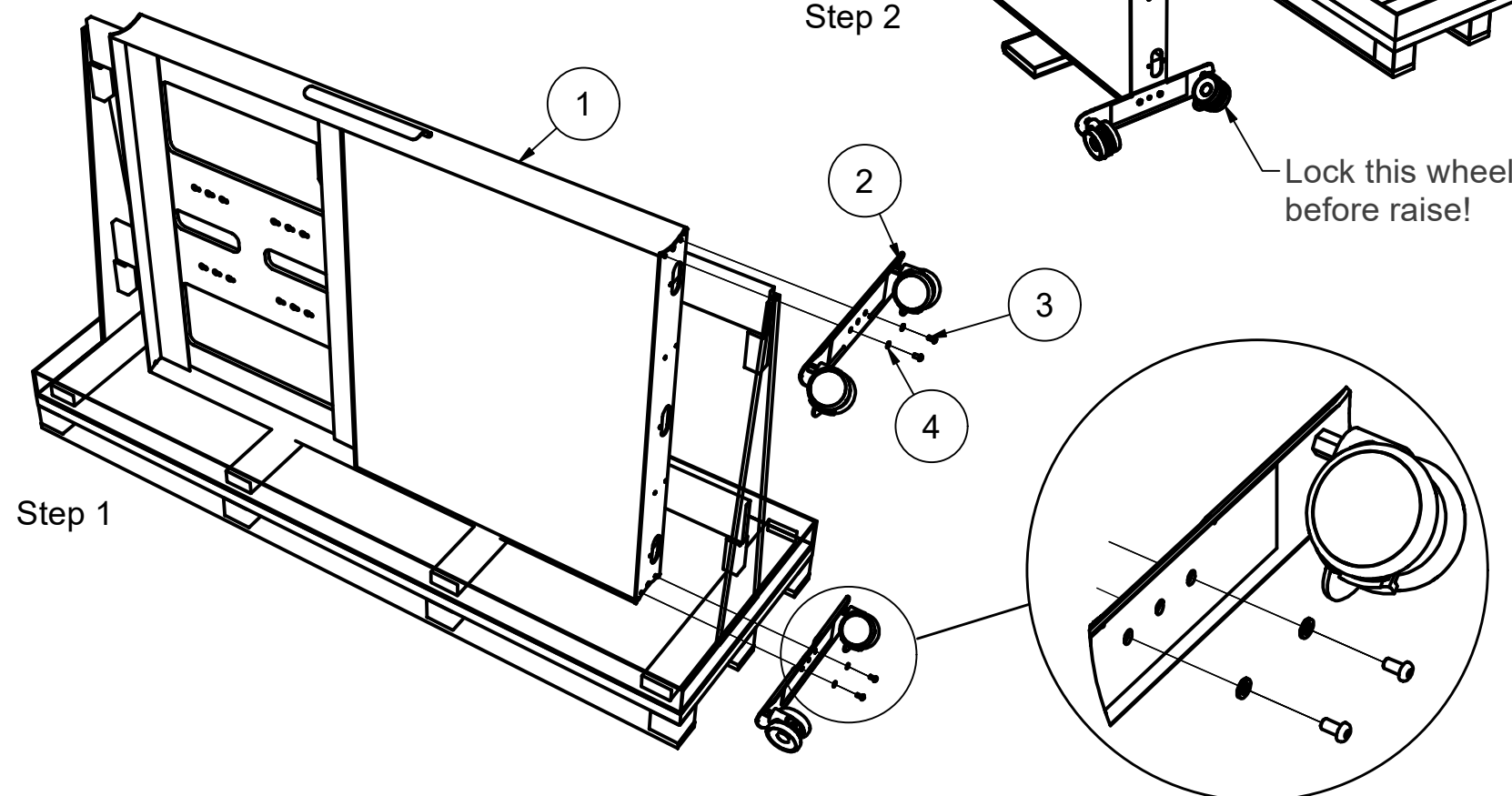

Step 2

Lock this wheel before raise!

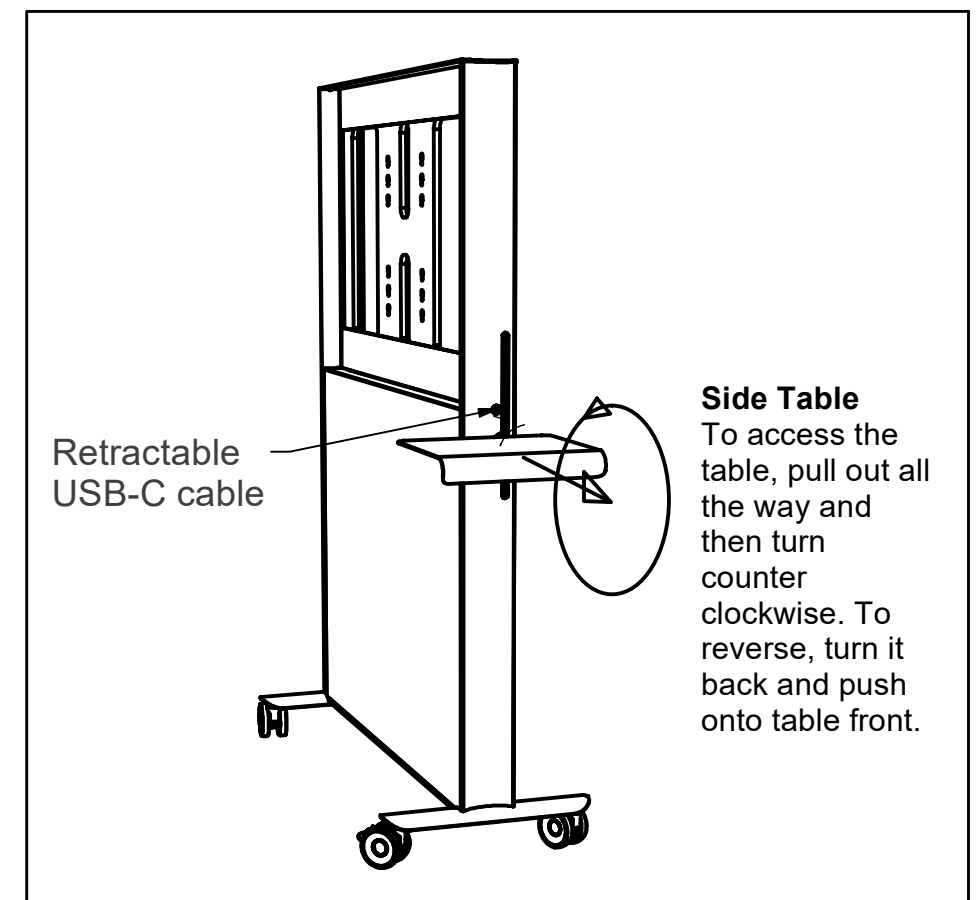
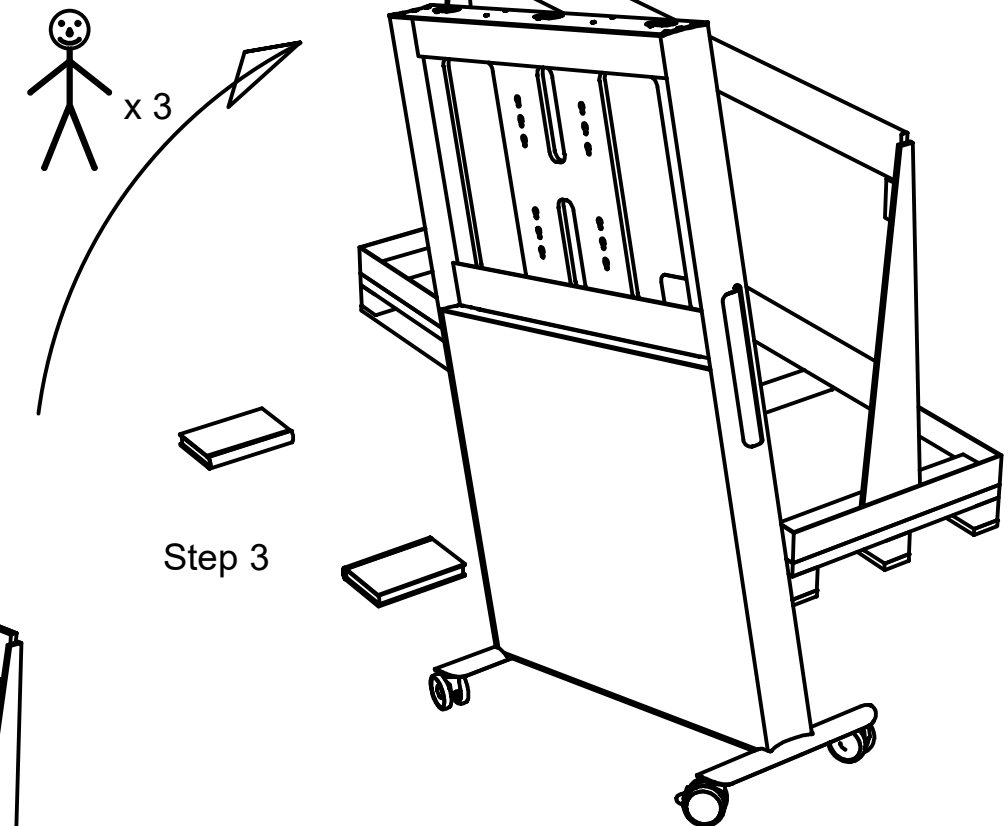

abstracta

Agile

Bruksanvisning / Use Instructions ver 1.0

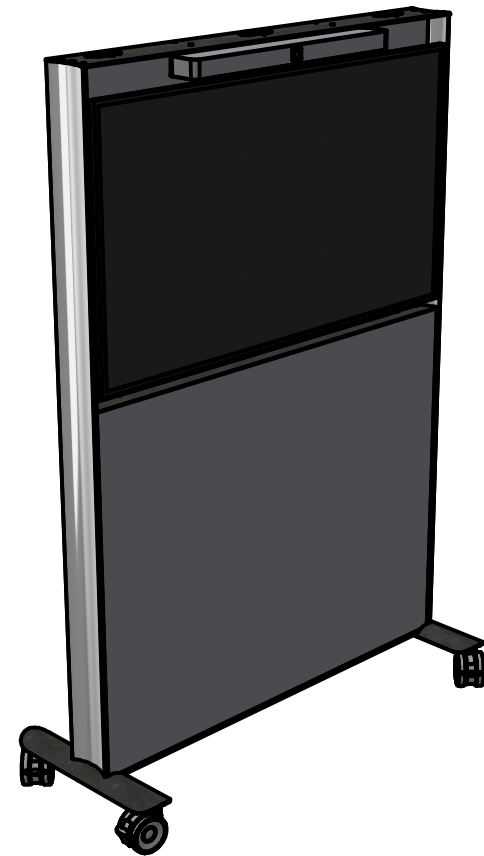

USB-C Connector to conference equipment etc. Alternative for high position.

USB-C Connector. Alternative for low position of conference equipment etc. Use the lower extra cable clip that is unused!

Remove cable!

Place here!

Attention! See that all cables and excess of cables are not interfering with the cable retraction or table mechanism. Use cable ties or similar to make sure they don't fall into such positions in the future. You can also squeeze in cables between the boards and the acoustic filling to keep them into position.

Retracting USB-C connector - To Computer
This will allow about 45 cm cable length.

Access the inside

Have clean hands!
Grab behind panel top and front panel with two hands, pull hard near one upper corner at a time, to loosen the magnetic connections and lift off the panel.

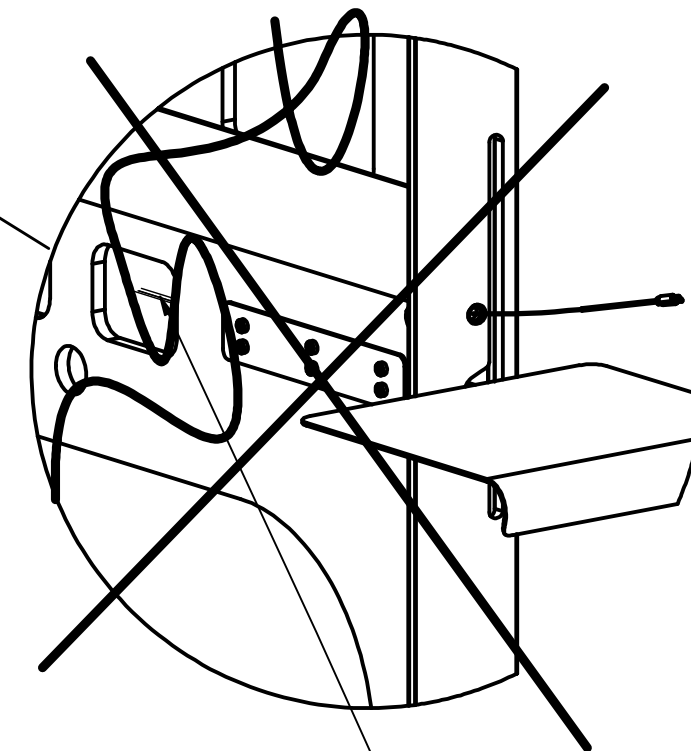
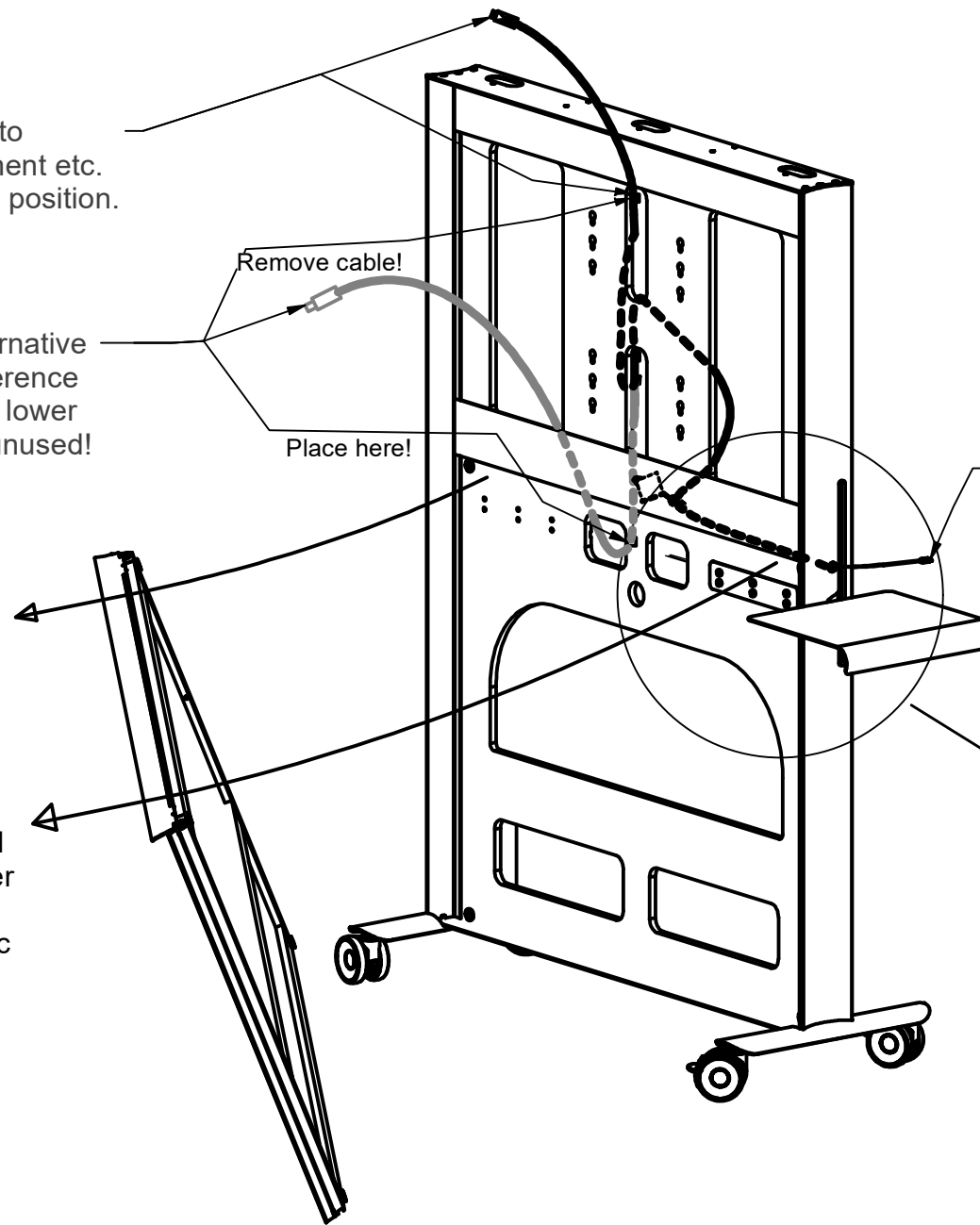

All cables shall be attached away from the retractable cable and table mechanism!
See that no cables interfere!

Preparing retractable USB-C cable

This cable is already prepared for having a high position, but can be reorganized low, for the cable to come out underneath the display screen. Use the cable clips on the inside of the board to rearrange the cable for your needs and make sure that it don't interfere with the movable parts inside. Use the USB-C-connector inside Agile to connect to your permanent installed electronic equipment. If you are installing Abstracta's recommended conference equipment that demands another kind of USB-C cable, please go through the chapter below.

Exchanging USB-C cable

Step 1. First notice and note how the cable is placed before removing the old one. Make a sketch of how it is placed.

Step 2. Remove the plastic seat were the USB-C comes out, by pulling the cable slightly harder until the seat loosen and take it of the cable. If it is hard to get it loose, try to push it with a finger from the inside at the same time as pulling the cable.

Step 3. Let the cable retract. From inside, take the cable off the plastic link attached to the retractor by unwinding the locking wire. Notice that the cable have a tape at the right length (maximum 49 cm of cable, excluding connector). Notice also that the cable might have to be connected in a specific direction. Usually the computer-side is marked with "Source".

Step 4. Remove the cable totally from the cable clips. Mark the new cable with tape at the same length and make sure that the computer-side will be on the outside.

Step 5. Put the new cable in the same way with tape mark in the same position at the link and lock with the locking wire. Make sure that the cable have the slack needed to go out all the way, but not more than needed to avoid getting stuck with other parts.

Step 6. Run the USB-connector through the hole. From the outside, put on the plastic seat on the cable, turn the slot of the seat downwards "12 o'clock" and pull the seat into the hole. (For Bose VB1, use the special plastic seat attached with that kit.) Try out that the retractor functions satisfying.

Abstracta technical support,
tel.+46472269600.

Preparing cables and power supply

Exchange the USB-C cable to the one coming with Bose VB1 (See page 3). Install all the cables and fasten the Bose VB1 Power Supply to the double sided tape with the DC output cable upwards. Arrange cable excesses with the plastic covered wires, so they won't interfere with movable parts inside. This preparation can be arranged for alternative solutions. One is shown in the pictures on this page. When all equipment is in place: **Secure the main power cable with the plastic tube (9) and strap it tight to a loop around the board with a cable tie (8) so it won't become damaged at sharp edges!** (See picture below)

Mounting Bose VB1 (Sound Bar)

Step 1. Decide if you want the sound bar above or underneath the display screen (See the two alternatives on page 5). Mount the sound bar (Bose VB1) according to the Bose VB1 manual, but **use the four shortest screws that comes in a separate package or bag**. Before drilling and screwing, measure out a good gap between top of the sound bar and the inside of the frame above if sound bar above screen. A good gap is 10 mm. If placed underneath a 10 mm gap between panel metal top and the bottom of the sound bar is good. Also measure out that it is centered. **Tips!** Add on a bright tape strip to make the drill marks on. Drill and mount the wall bracket included with the VB1-package when you have the position correct. **Use a 3 mm drill.**

Step 2. Hold the sound bar and connect DC power, USB-C and HDMI connector to it, and place it onto the wall bracket. Fixate the sound bar with two of the shortest screws. Arrange cables so they won't interfere with the movable parts inside.

Mounting NEC Display Screen

Step 1. Remove the handles on the backside of the display screen. First mount pin screws (6) and cap nuts (5) together and screw them all the way till it stops. Then mount them into the threaded holes on the backside of the display screen together with the washers (7).

Step 2. Be two or three persons while hanging up the display screen. Hold the screen near to the cables and connect them. Hook on the display screen to four of the keyholes on the board. Use the middle holes for VB1 on top and the upper holes for VB1 underneath screen. Make sure all four hanging points are in place by slightly pulling each corner of the screen. See that it hangs straight.

Parts included with Agile

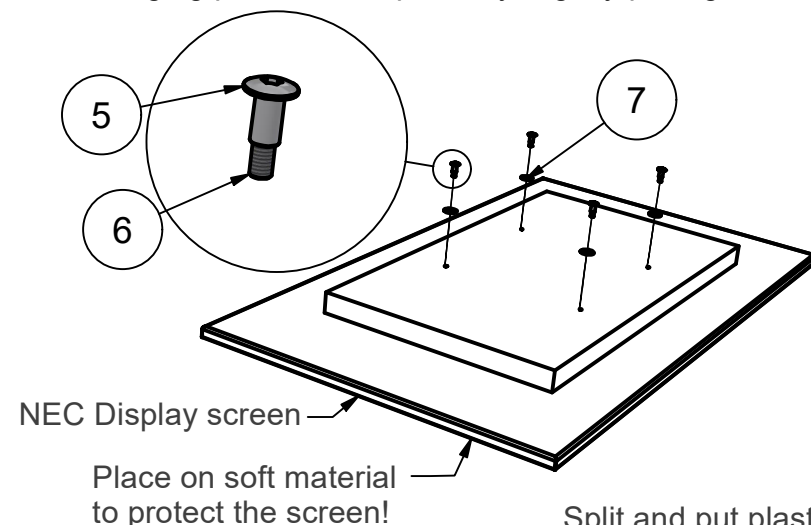
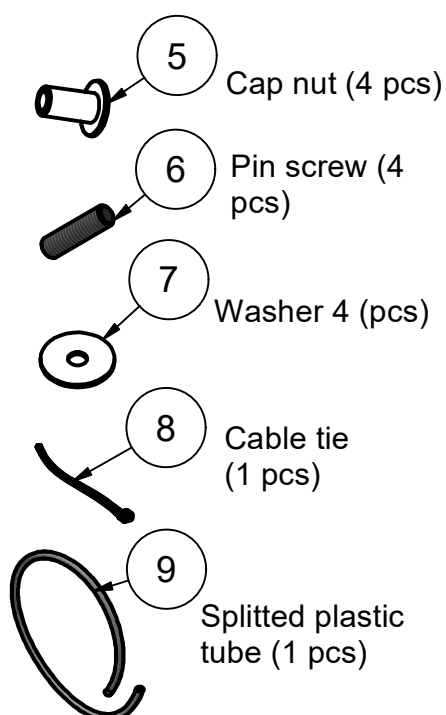

Split and put plastic tube around power cable to protect from damage at metal edges.

Secure main power cable!

Strap cable and plastic tube to a loop around the board, tight with a cable tie. Use a location that fits your needs and will lock the cable and tube.

Bose VB1. (See Bose's manual for mounting instruction.)

Attention! For mounting Bose VB1, use the four shortest screws in separate package! Make sure that the screws and the drilling don't damage cables on the backside!

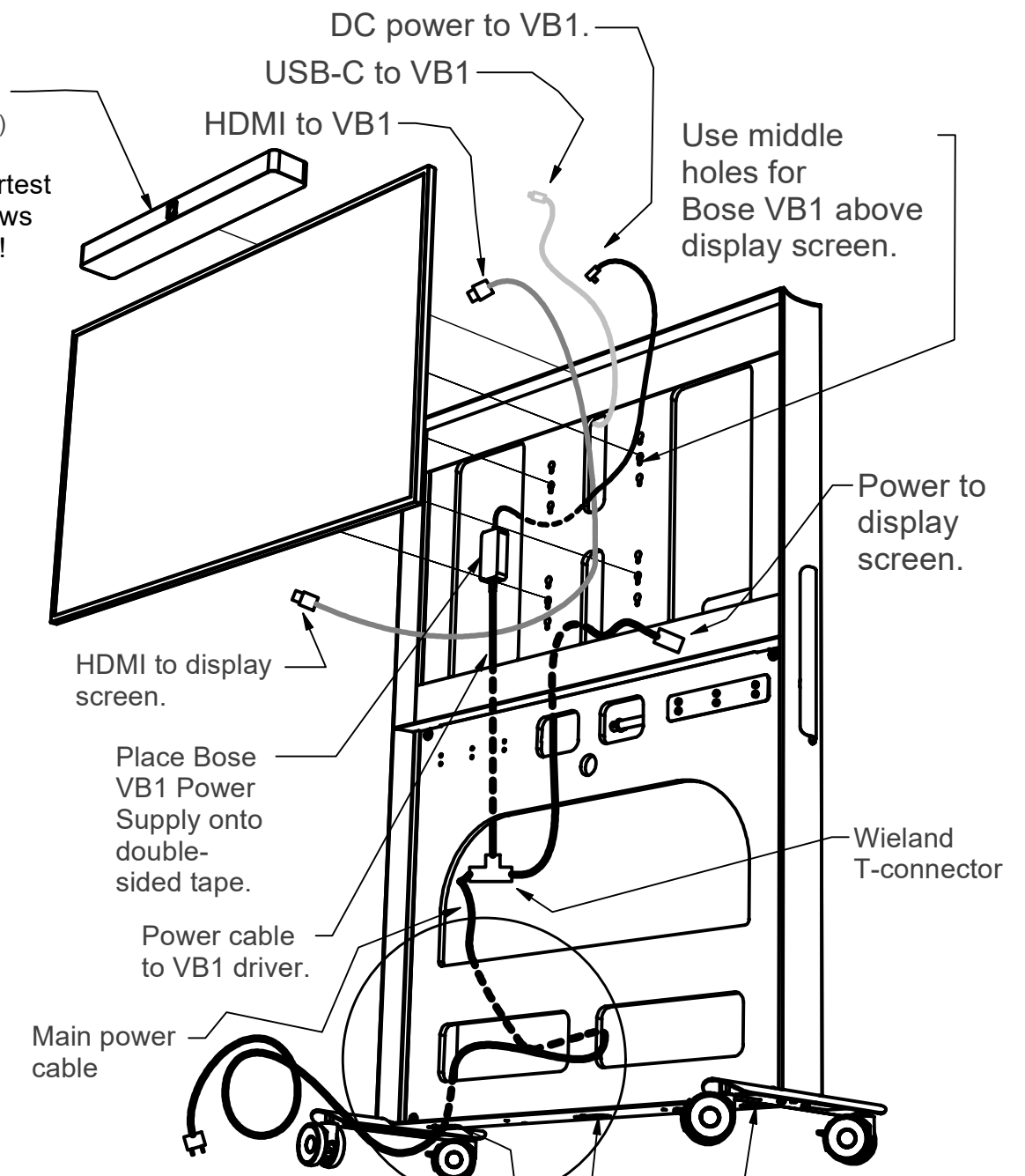

Mounting Bose VB1 and recommended distances

Measure out, drill (drillbit = 2,5 mm to 3,0 mm) and mount the wall bracket included with Bose VB1. **Attention!** Use the short screws in the separate package coming with the conference kit.

Sound bar above display screen

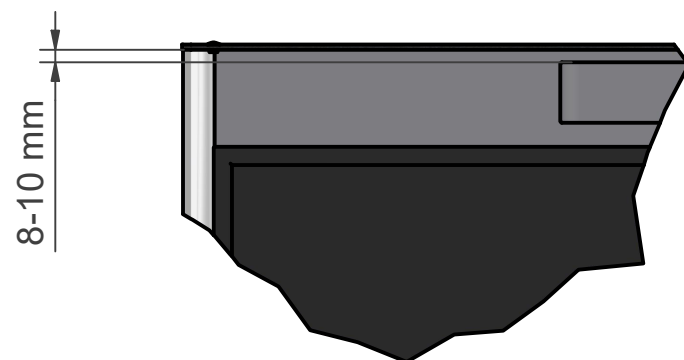
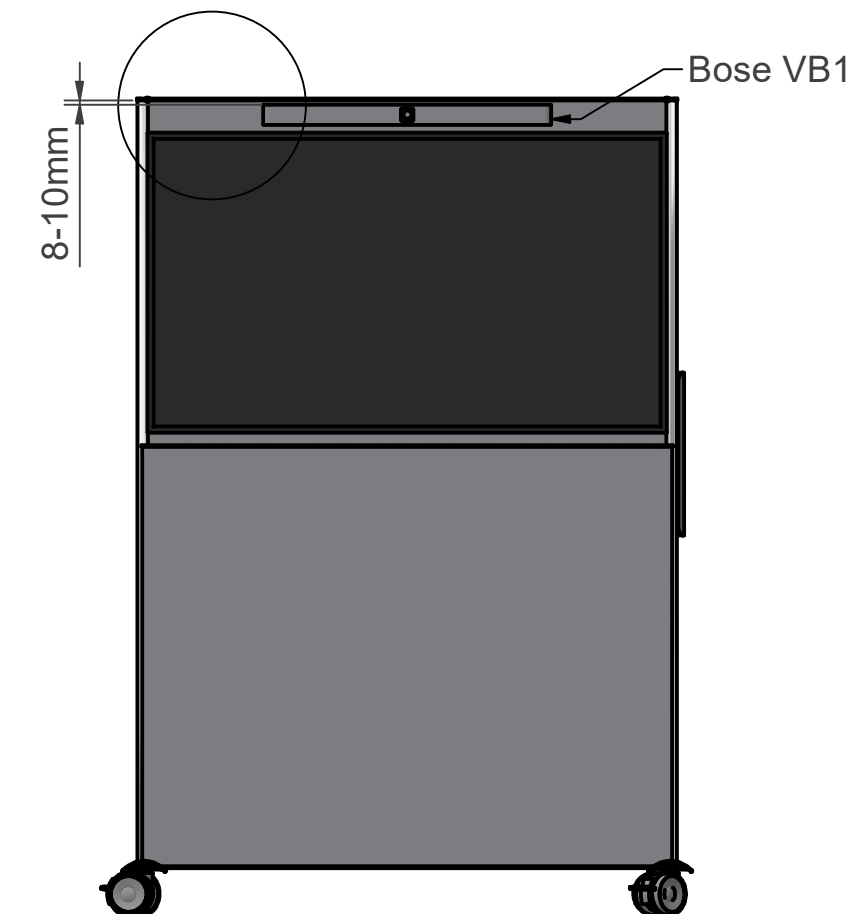

Sound bar underneath display screen

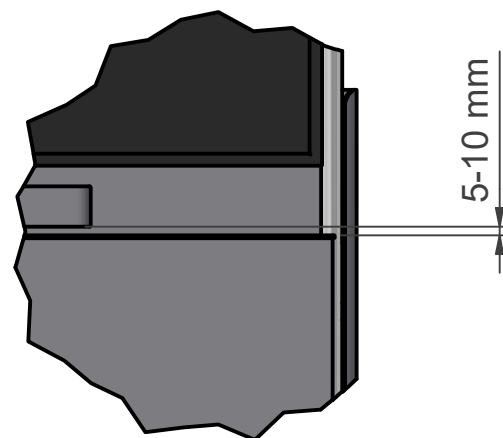
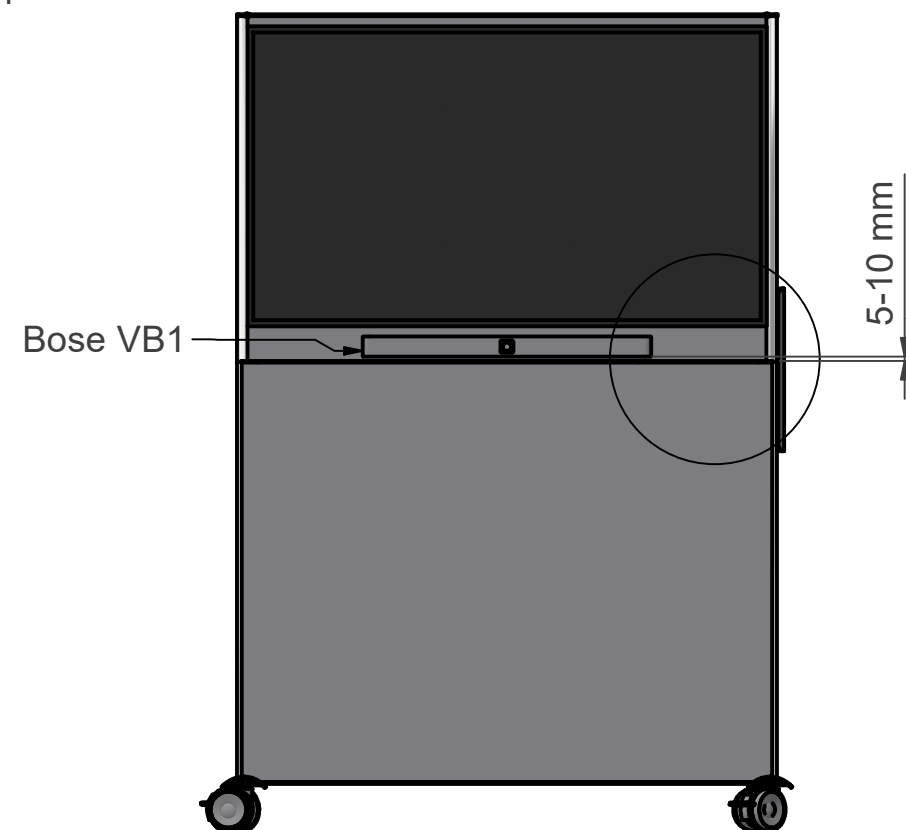

Get started!

- Connect a computer with internet connection and follow the instructions included with Bose VB1.

Or browse to:

pro.Bose.com/VB1LatestSW

- If needed: Follow the NEC display screen's manual, to get the video signal via the connected HDMI on the screen.

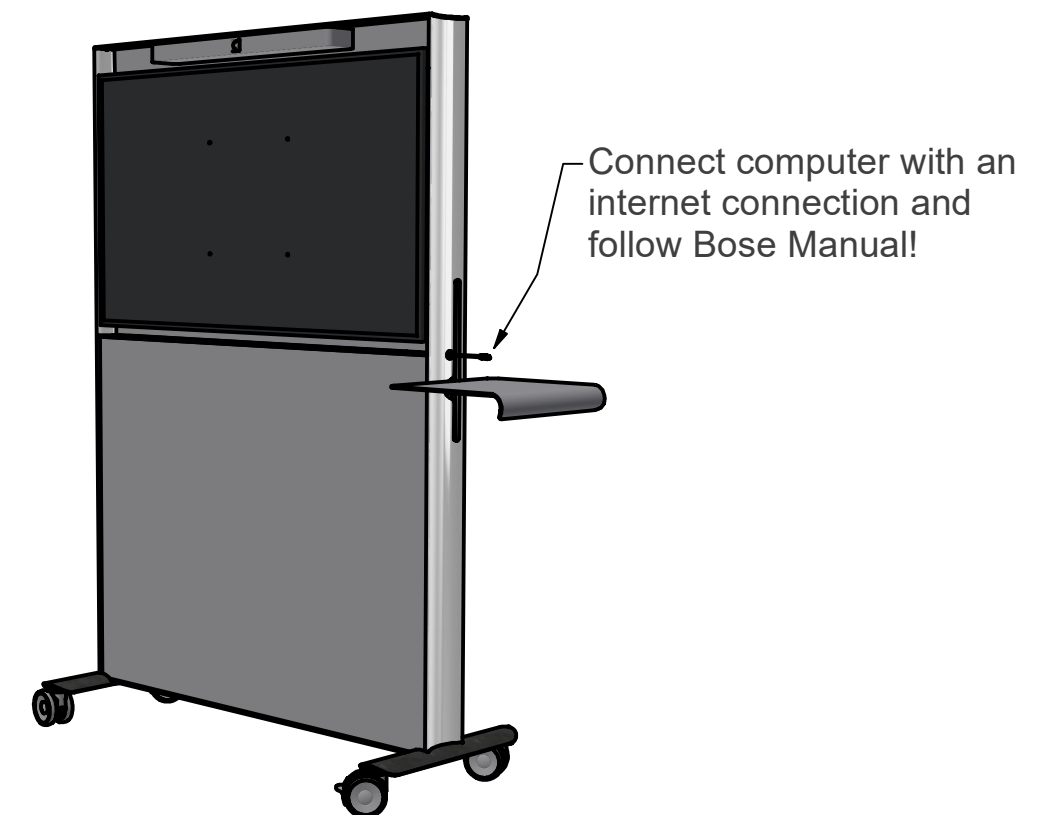

Guidelines for display screens for Agile.

If not using Abstracta's recommended display screen that we supply, please go through these guidelines before choosing and mounting the display screen to assure a good design. The premade mounting holes may not be usable. Measure out and mount onto the board. Make sure if drilling, that inside equipment will not be damaged. Do not use too long screws, they shall not go through the 16 mm mounting board!

USB-C

You will need a screen with a USB-C 3.1 or 2.0 connector to use the included retracting cable connection. Some USB-C don't access charging! USB-C 2.0 works, but doesn't allow charging the connected device. In some cases an adapter to USB-C can be used. Ask the display screen supplier!

Brackets

If using an alternative standard screen bracket, Abstracta recommend as thin as possible (about 10-20 mm thickness). Screen and bracket together should not exceed a thickness of 75 mm, for good design. Best design is no more than 65 mm.

Measures

A. 1237 mm = width (approx.) of Abstracta's recommended screen. Less or equal than this width will always fit Agile.

B. 714 mm = height (approx.) of Abstracta's recommended screen.

C. 1253 mm = Max. recommended screen width. (Screen backside minimum 42 mm from Agile's mounting board).

D. 42 mm = Distance for our recommended screen (backside of display screen to mounting board). Increasing this measure allows 0,9 mm wider display screen, for every 1 mm added. Calculation example. D = 50 mm gives: $(50-42) \times 0,9 + 1253 = 1260$ mm width.

In any case you shall not use screens wider than 1270 mm.

If instead going closer to the mounting board see first that the screen will fit. This may happen if using a thinner screen. See that the bracket and screen together, can bring the depth needed.

E. 1270 mm = Max. inside width of frame. Abstracta don't recommend to use display screens wider than the inside of the frame, due to decreased balance and looks.

F. 821 mm = Max. height of mounting area.

Attention! If using e.g. added soundbar or camera, make sure there is space enough above for e.g. lifting onto hooking brackets.

G. 30 mm = Recommended gap between display screen and panel top. Absolute min. gap is 18 mm. If closer gap you can hurt or lock your fingers while putting the screen onto the bracket, or be difficult to remove the screen later.

H. 61 mm = Depth of Agile's framing. A screen assembly may be 10 -15 mm thicker than this without decreasing the looks. A very thin display geometry may not look good, if the backside of the display is visible outside the framing.

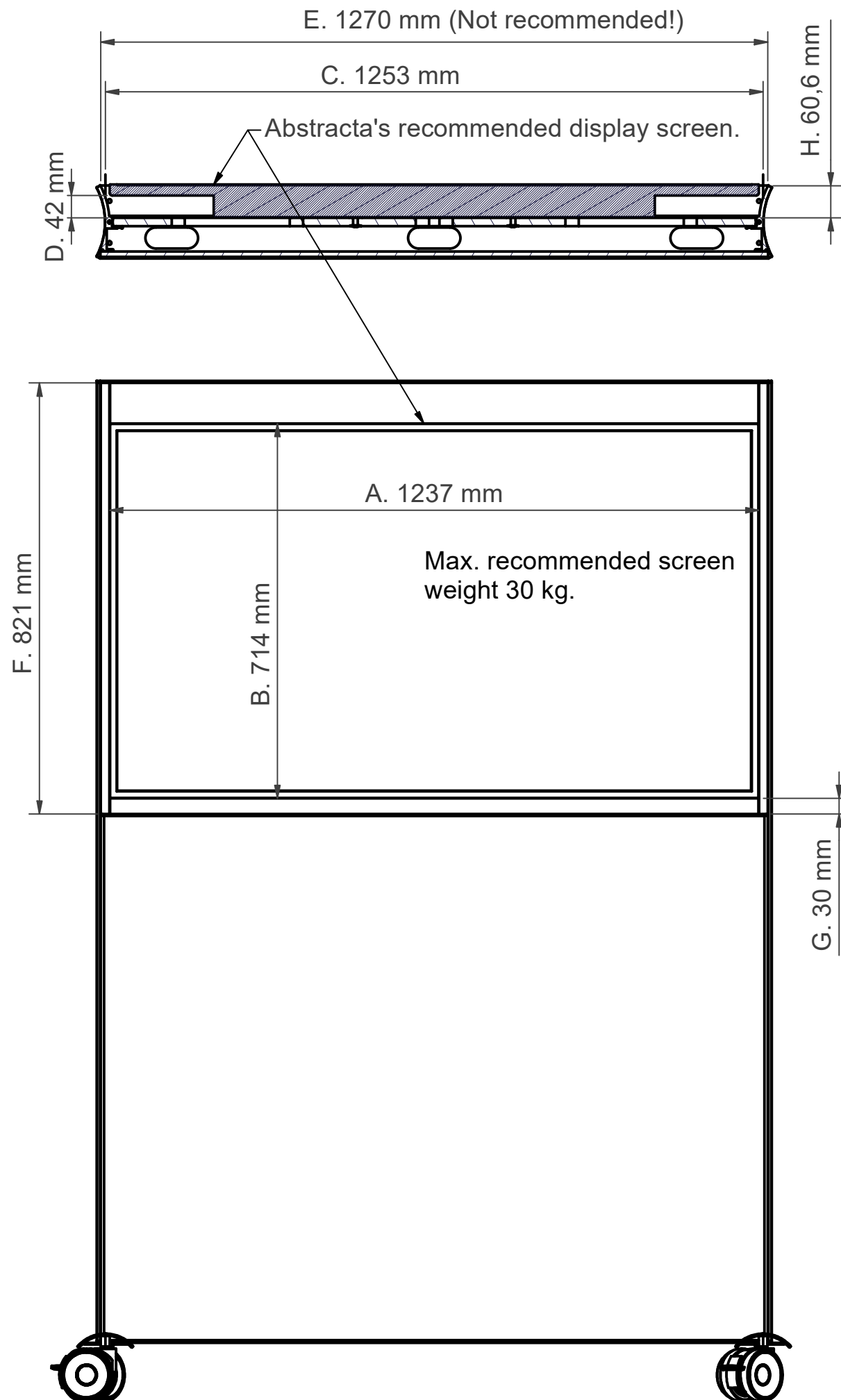

Including components

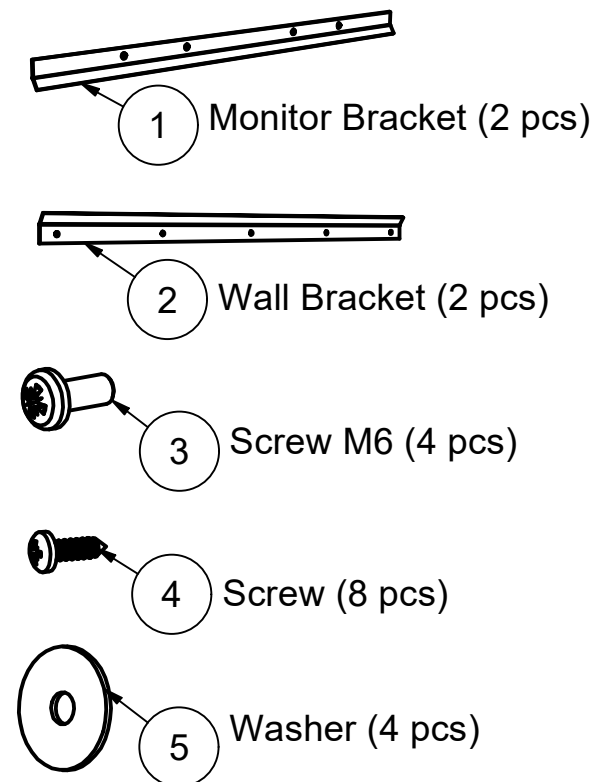

1. Mount the Monitor Brackets.
(Positions in next step)

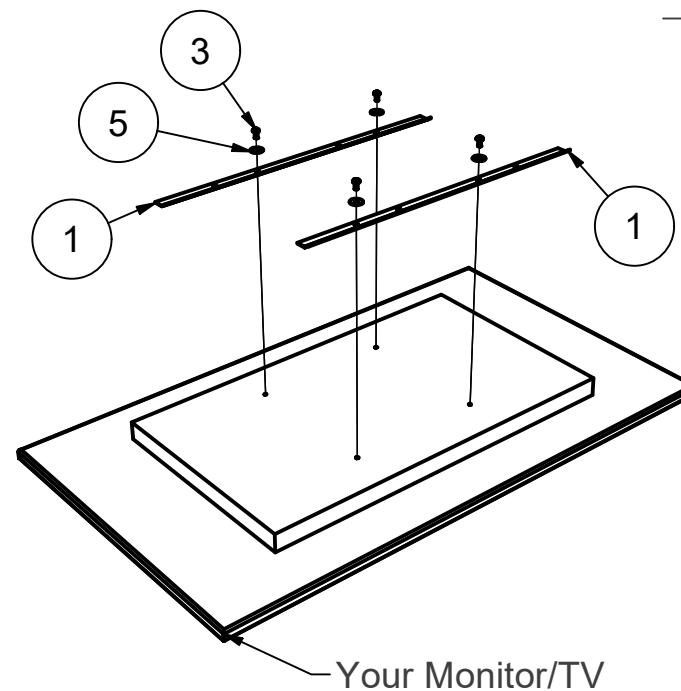

2. Measure and note "X" and "Y" for your monitor/TV.

X = your measured distance!

Backside of your monitor/TV

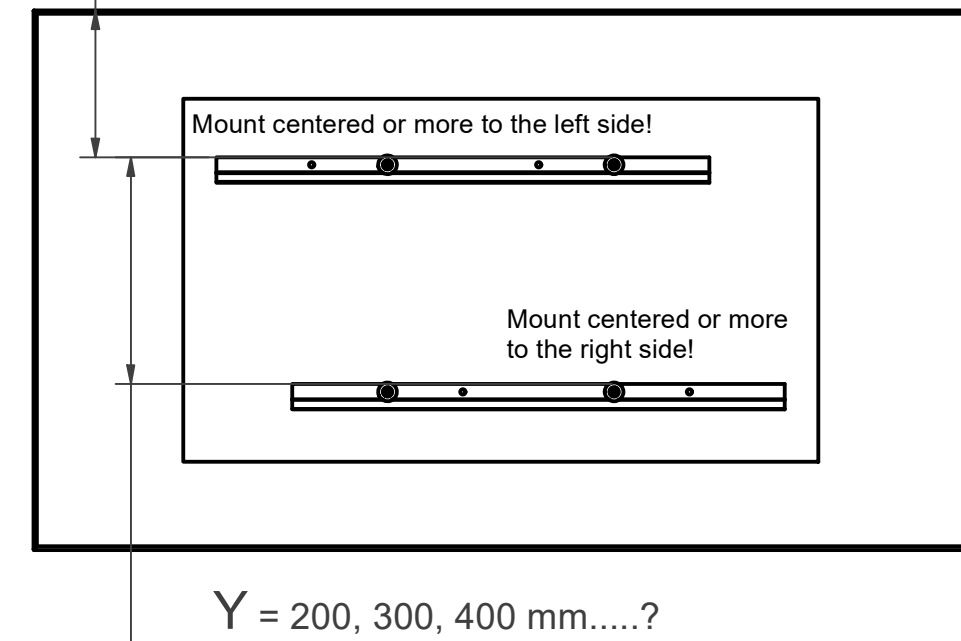

3. Decide your gap "Z" (between
your monitor/TV top and inside of
the top frame of Abstracta Agile).

Z = Your wanted gap! (Min. 12 mm)

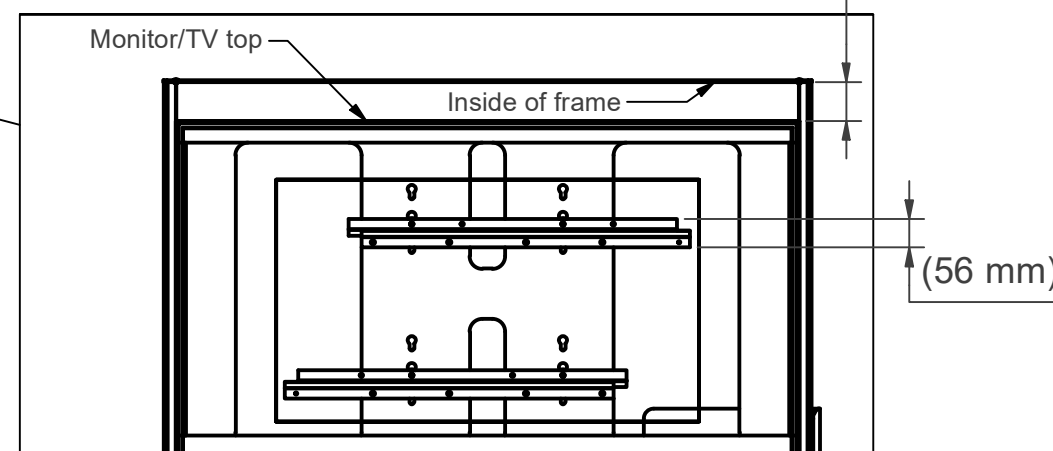
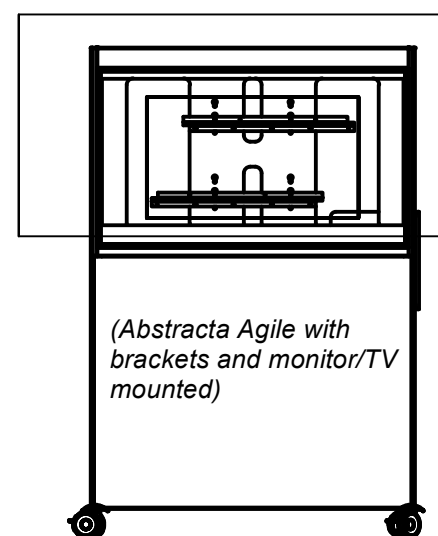

4. Calculate "H1" and mark out this with a straight, perpendicular line. Place the top Monitor Bracket to your line, like the picture shows (don't screw). Mark out four of the bracket holes to the mounting board with a pencil. Calculate "H2" and mark out in the same way for the bottom bracket. Use a sharp tipped tool to punch deeper center marks for easier screwing!

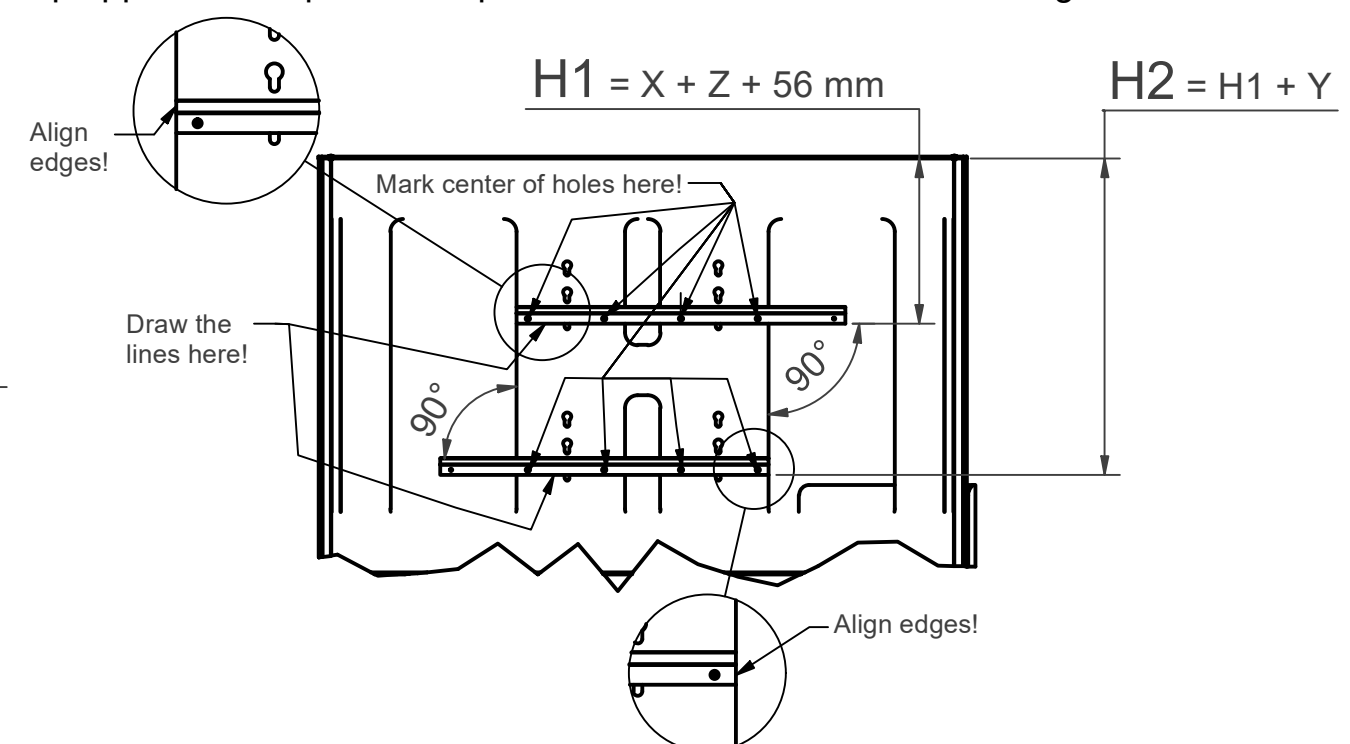

5. Mount the wallbrackets with the screws into your marks.

- Remove the panel by grabbing behind panel top and pulling quick and hard. (Magnetic)

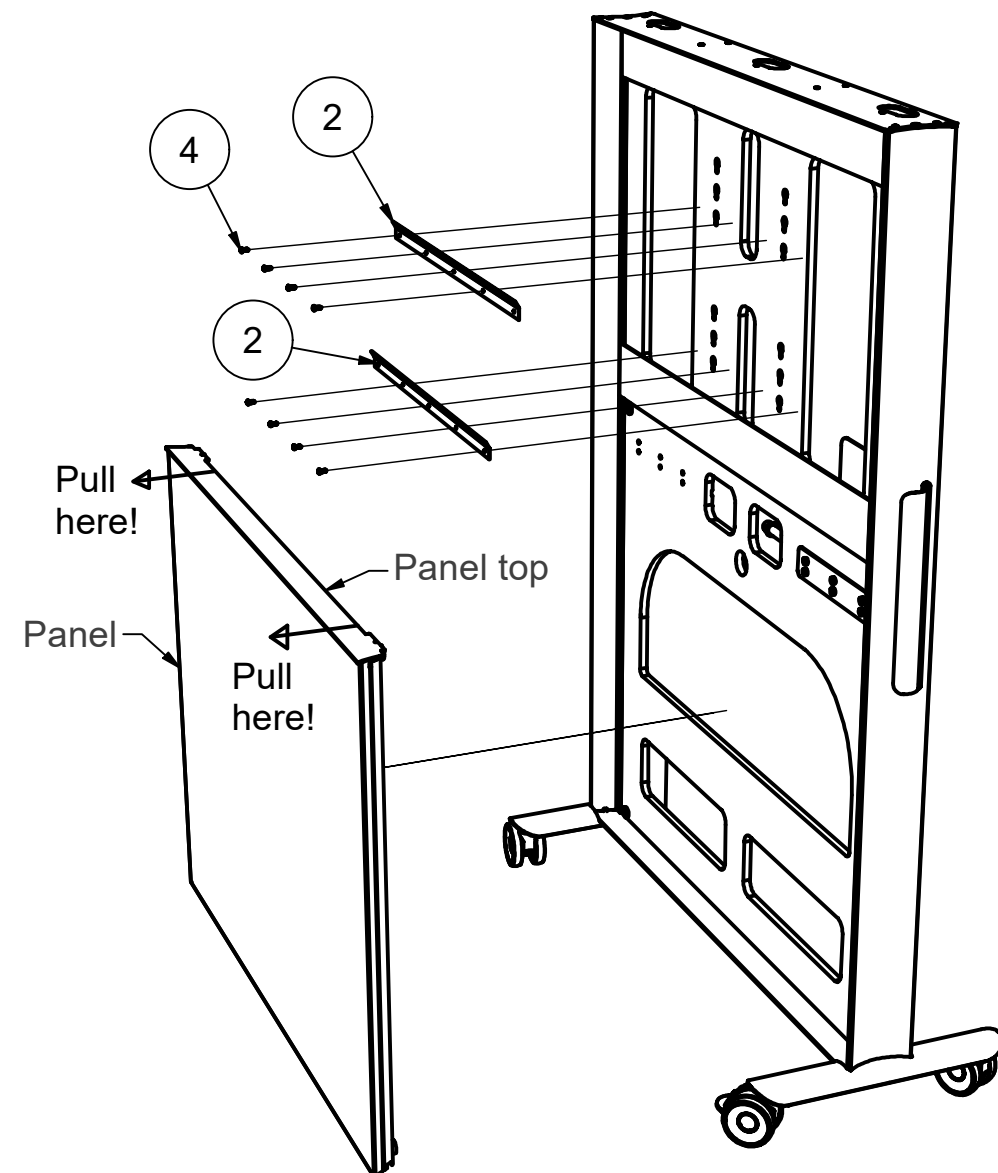

4. Place your cables needed for the monitor/TV or other equipment.

- Keep cables fixed and away from the movable parts inside!

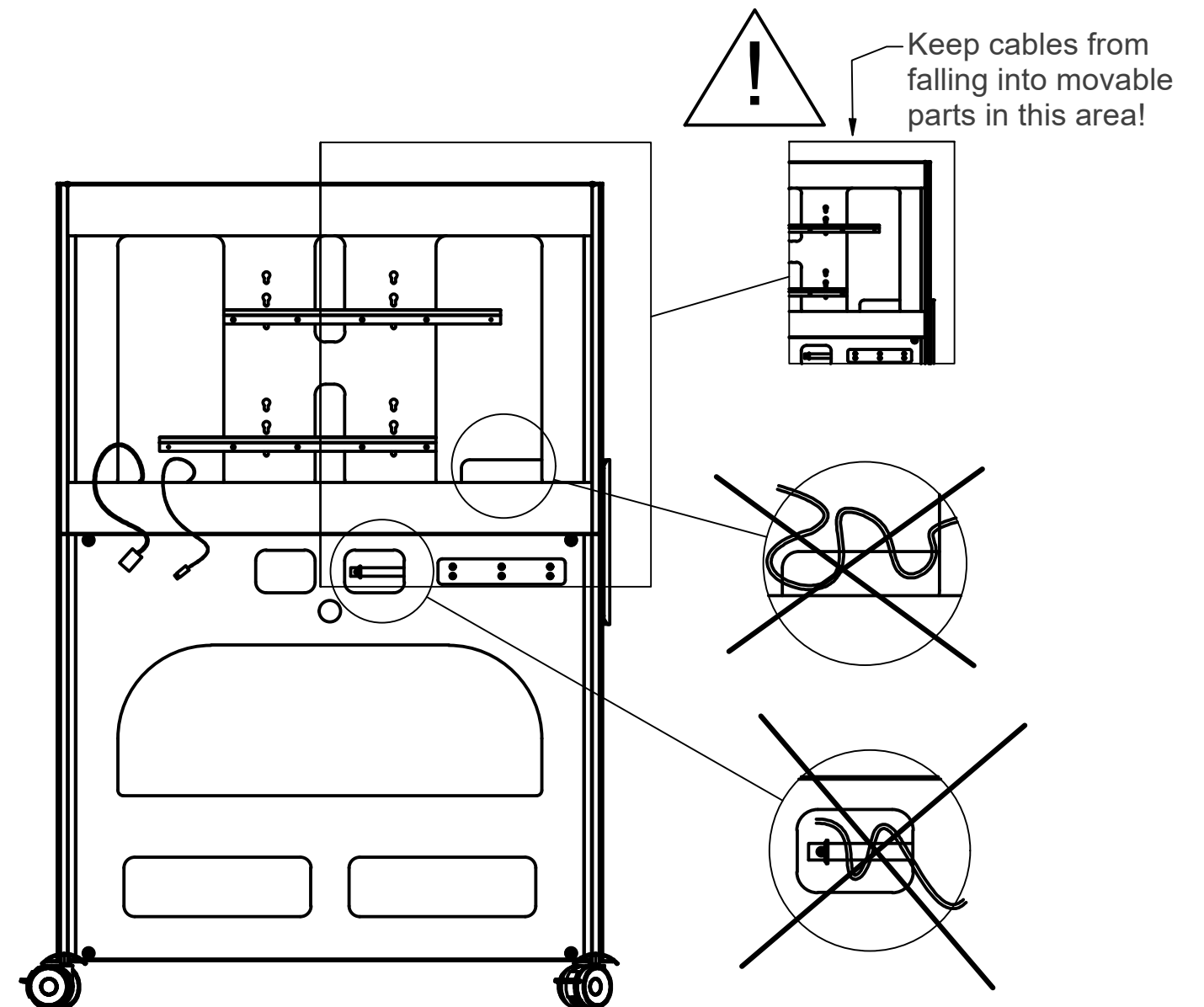

5. Put your monitor/TV onto a soft surface on a table.
- Connect your cables.
 - See "Abstracta Agile" user instructions for further cable instructions!

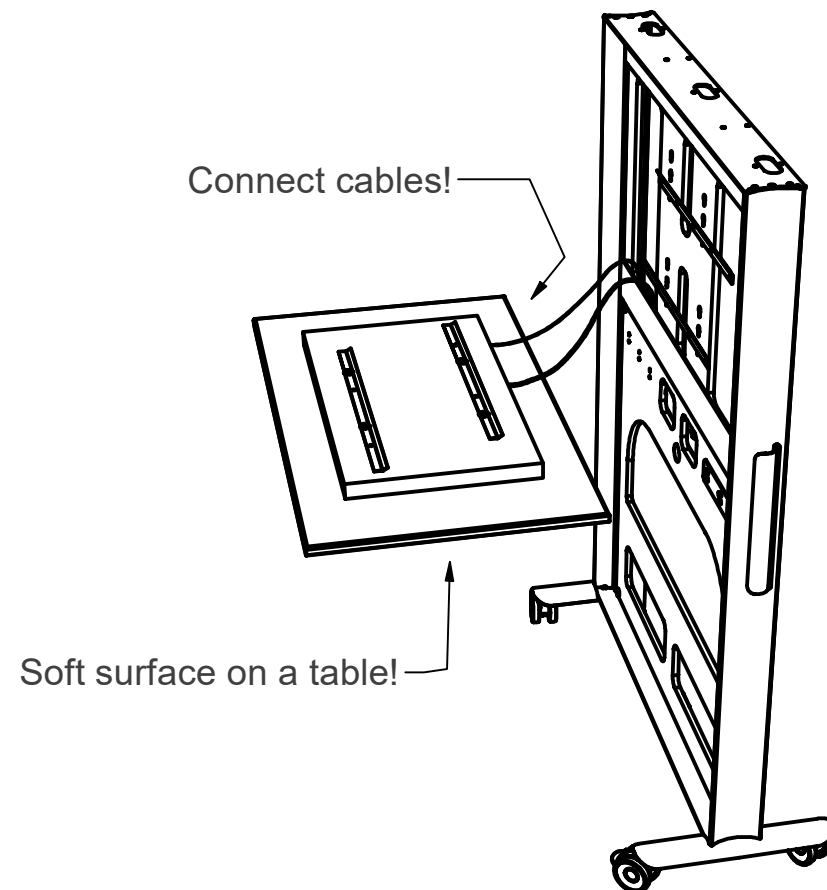

6. Hang the Monitor/TV onto the brackets and make sure it is straight and hanging on both brackets. Be two persons!

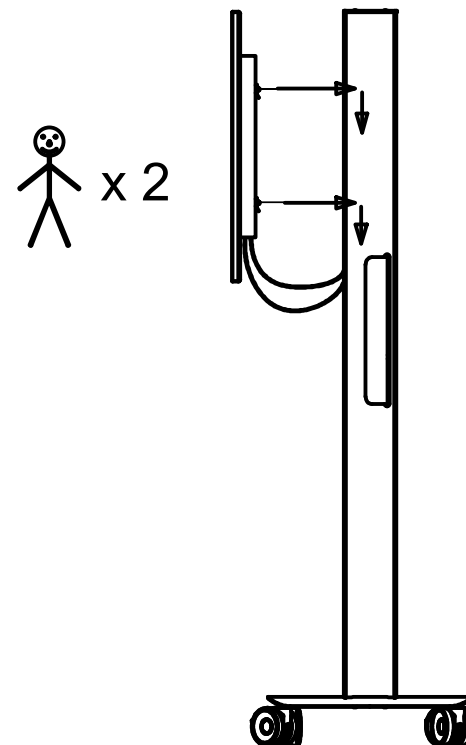

7. Center the Monitor/TV, hide visible excess of cables behind the monitor and in the lower space. Put back the panel and panel top.

