

ABSTRACTA

My Hive Sofa

Monteringsanvisning/ Assembly Instructions ver 1.0

Including components:

- 1



Screw (4x)
- 2



Shaft (6x)
- 3

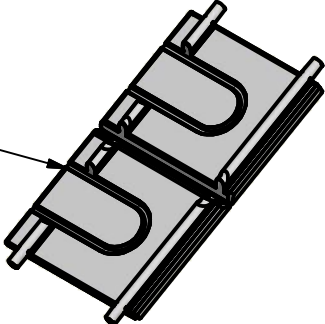

Plastic foldable corner (2x)
- 4



Screw (10x)
- 5



Screw (4x)
- 6



Washer (4x)
- 7



Bracket (2x)

Notes!
1. For electrical installation use only authorized electricians.

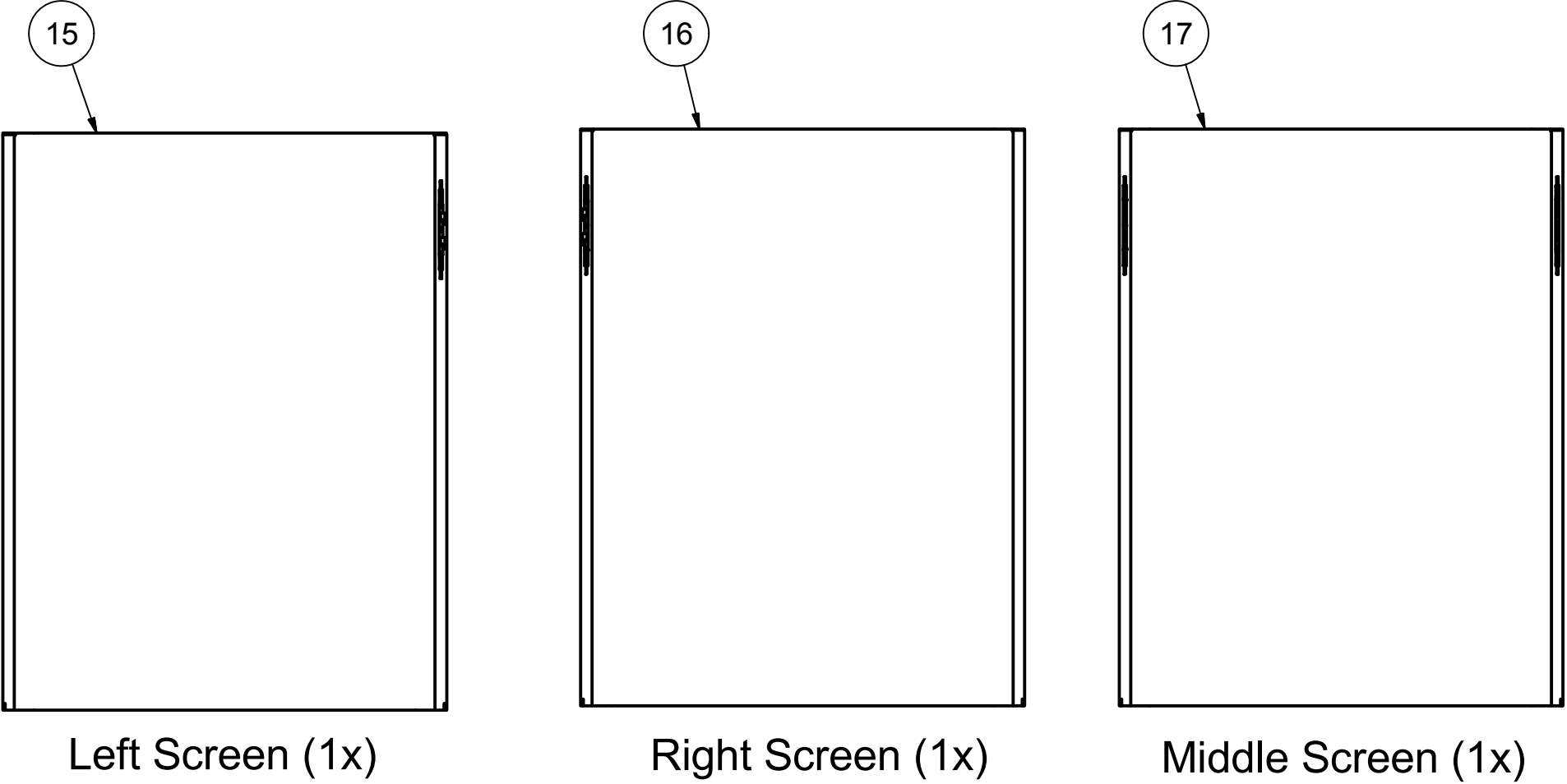
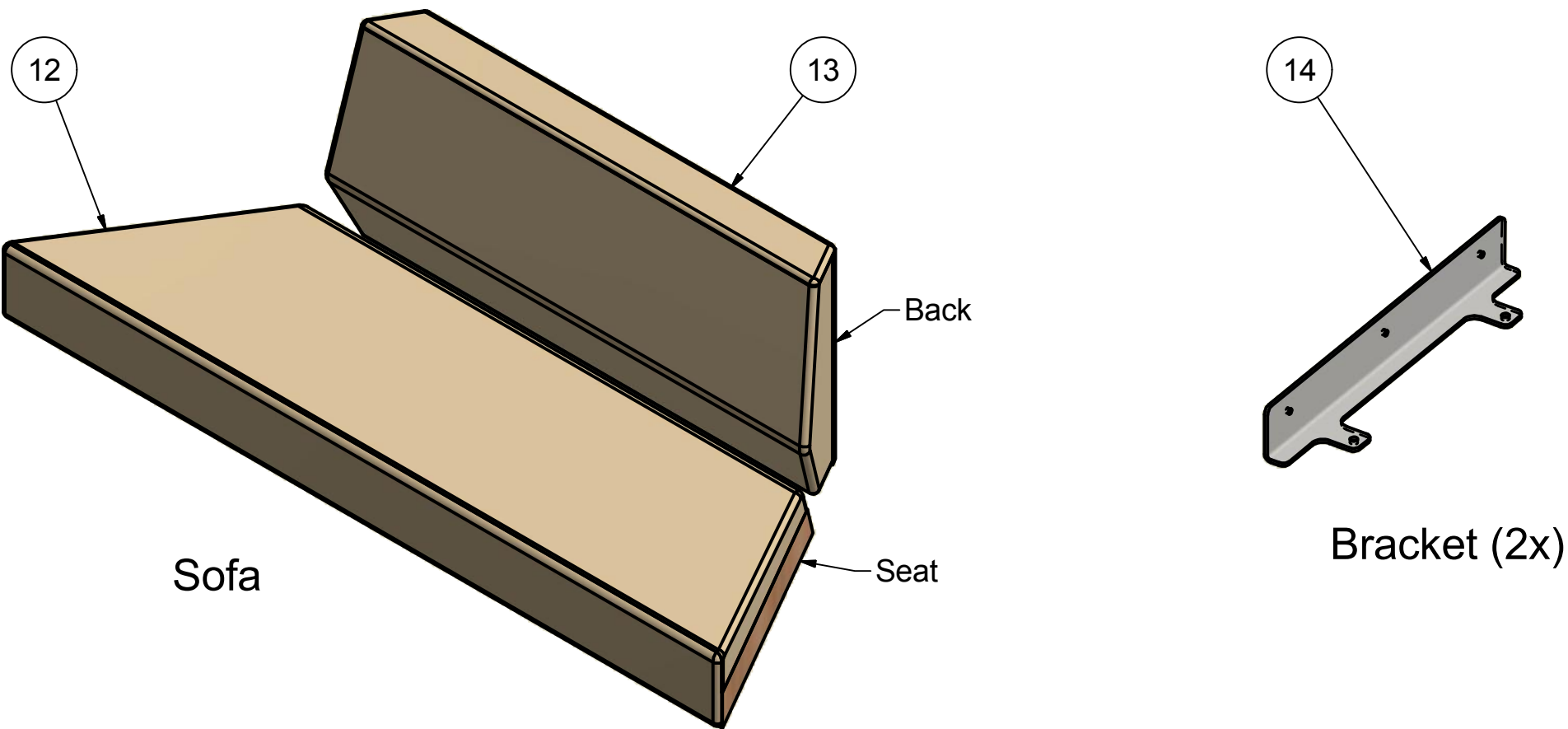
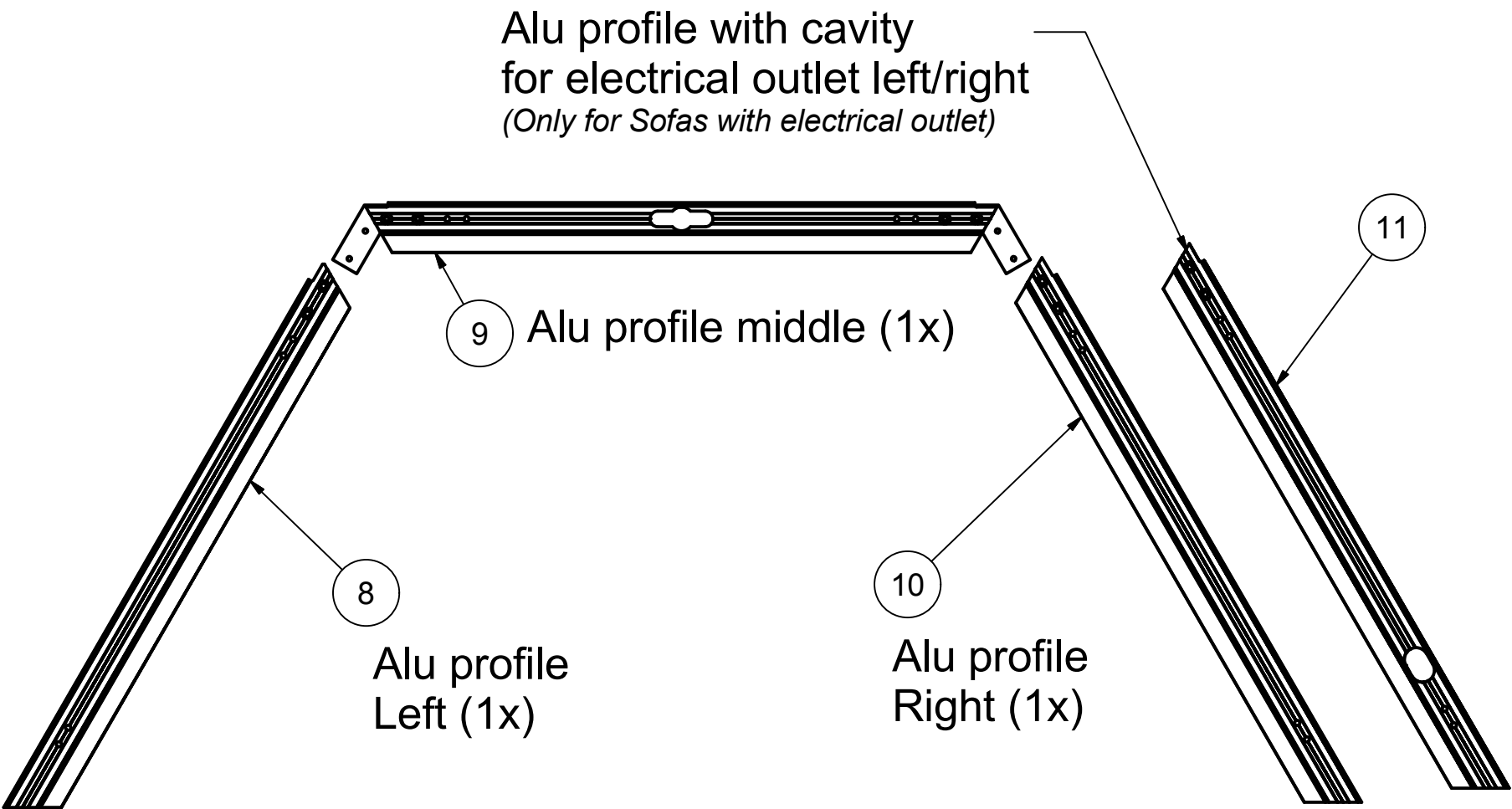

ABSTRACTA

My Hive Sofa

Monteringsanvisning/ Assembly Instructions ver 1.0

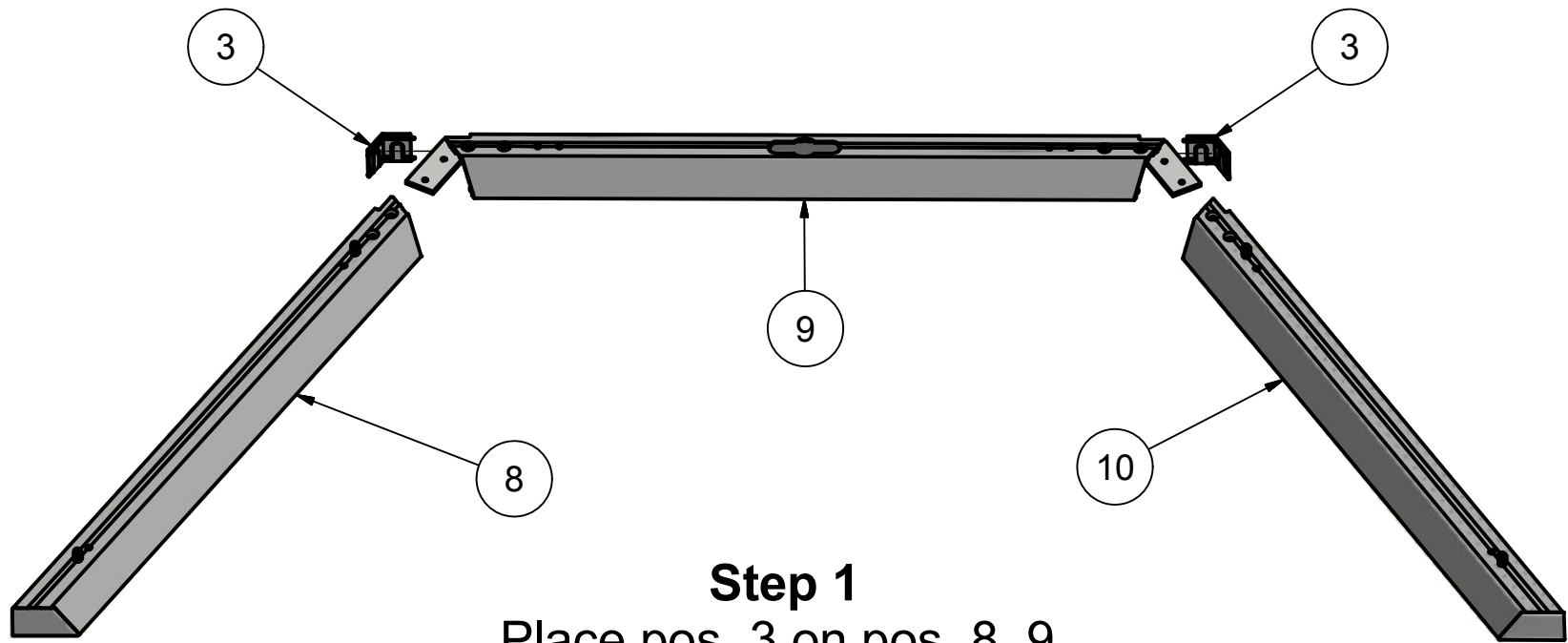
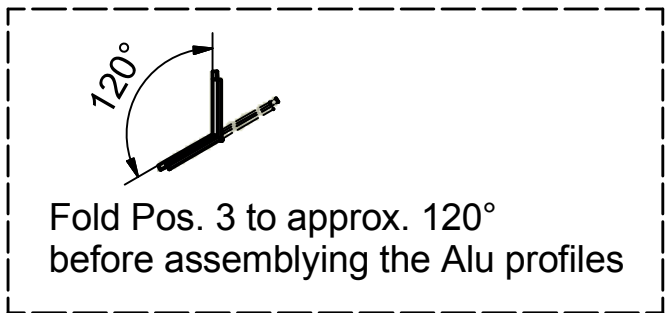
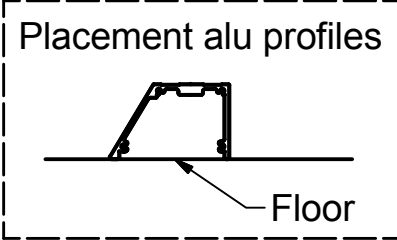

Step 1

Place pos. 3 on pos. 8, 9 and pos. 10 before step 3.

Place profile with electrical outlet left/ right.
(Only for Sofas with electrical outlet)

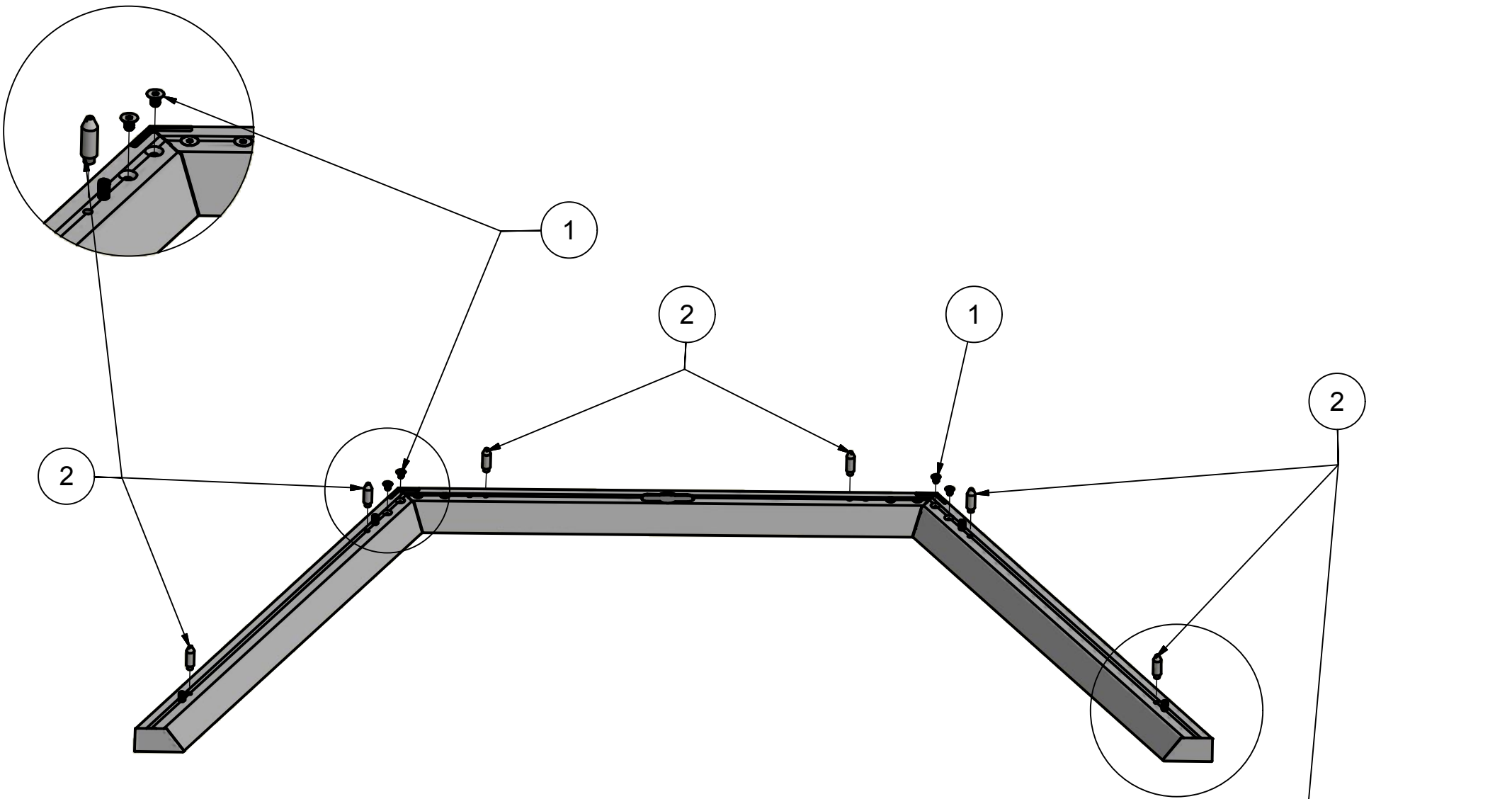

Step 2

Before step 3 make sure that frame are placed flat horizontally on floor

See Screen connectors guide when assembling multiple units

Use the pre-assembled feets to set frame horizontally

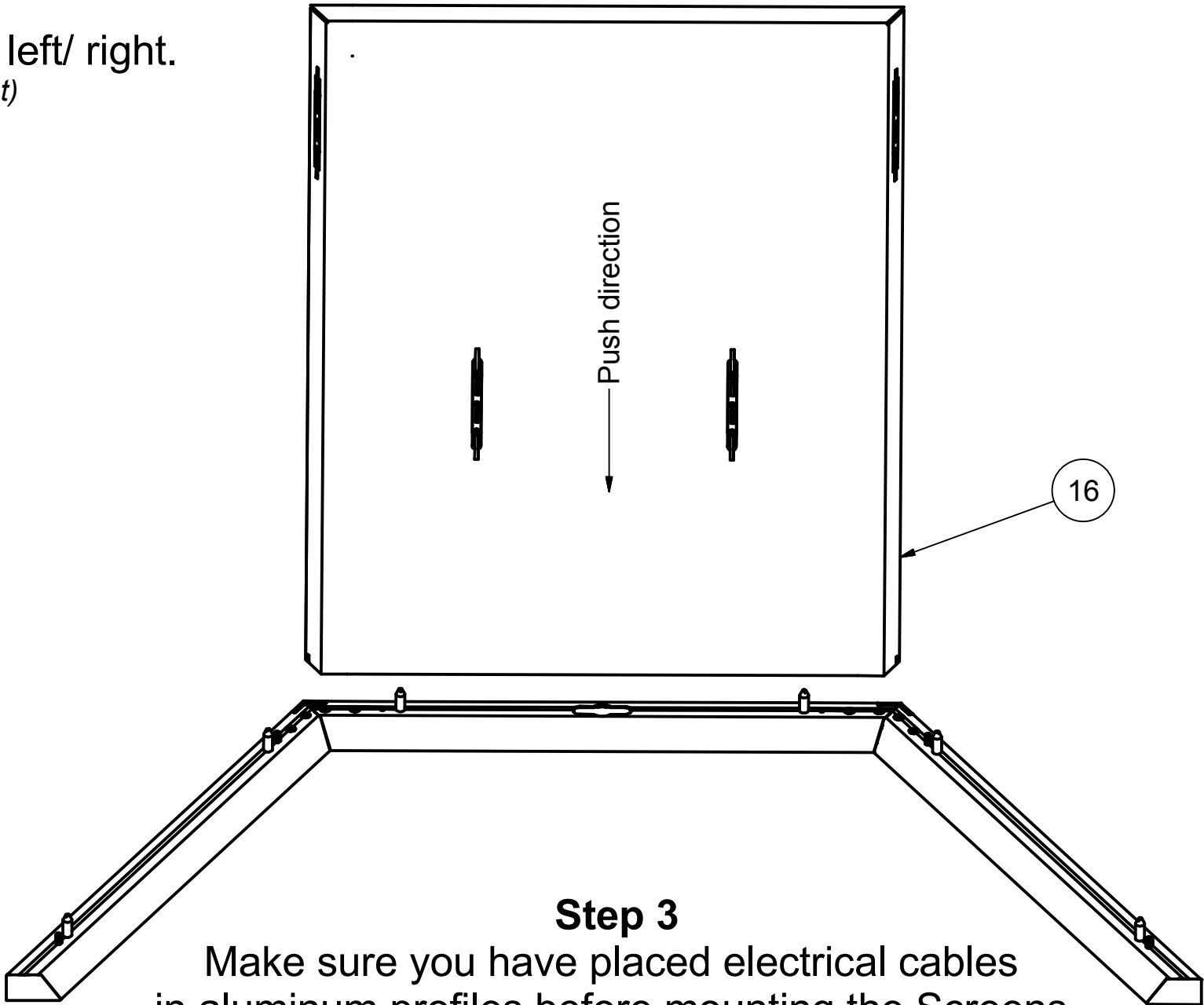
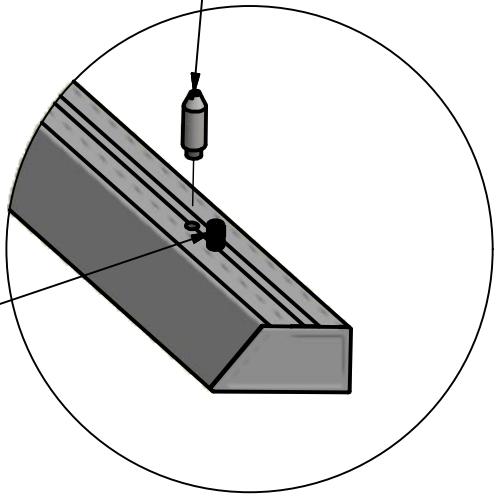

Step 3

Make sure you have placed electrical cables in aluminum profiles before mounting the Screens.

ABSTRACTA

My Hive Sofa

Monteringsanvisning/ Assembly Instructions ver 1.0

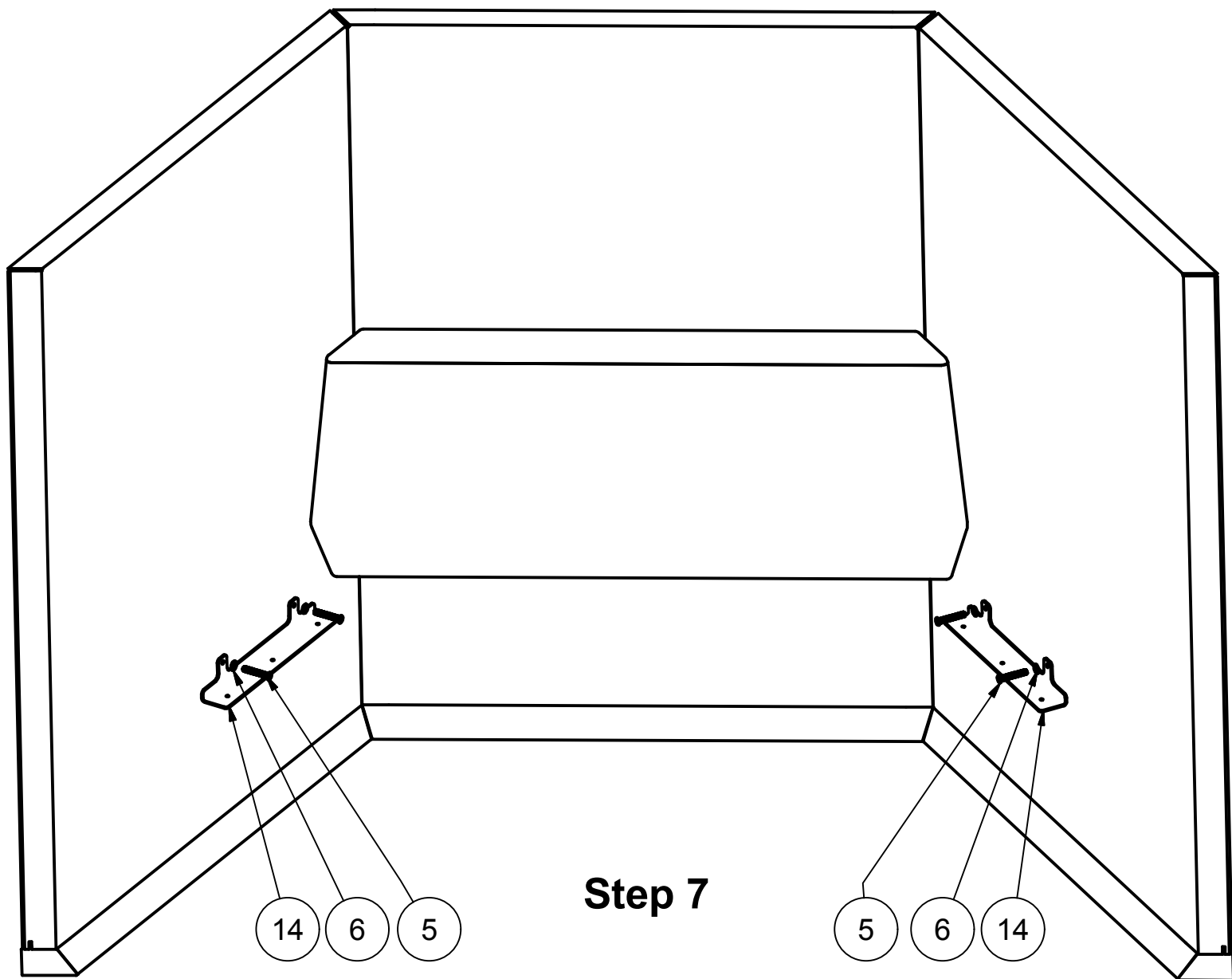
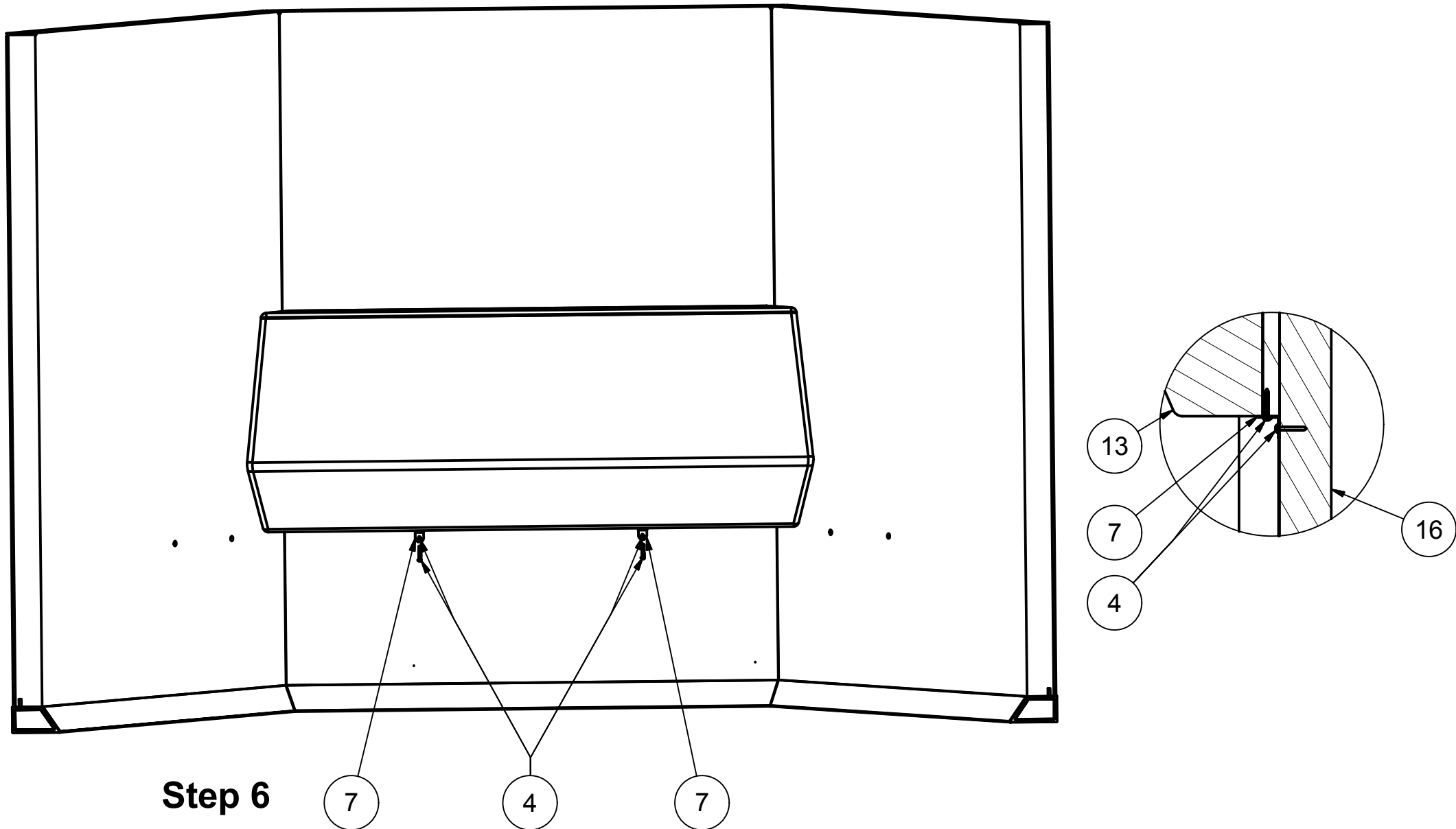
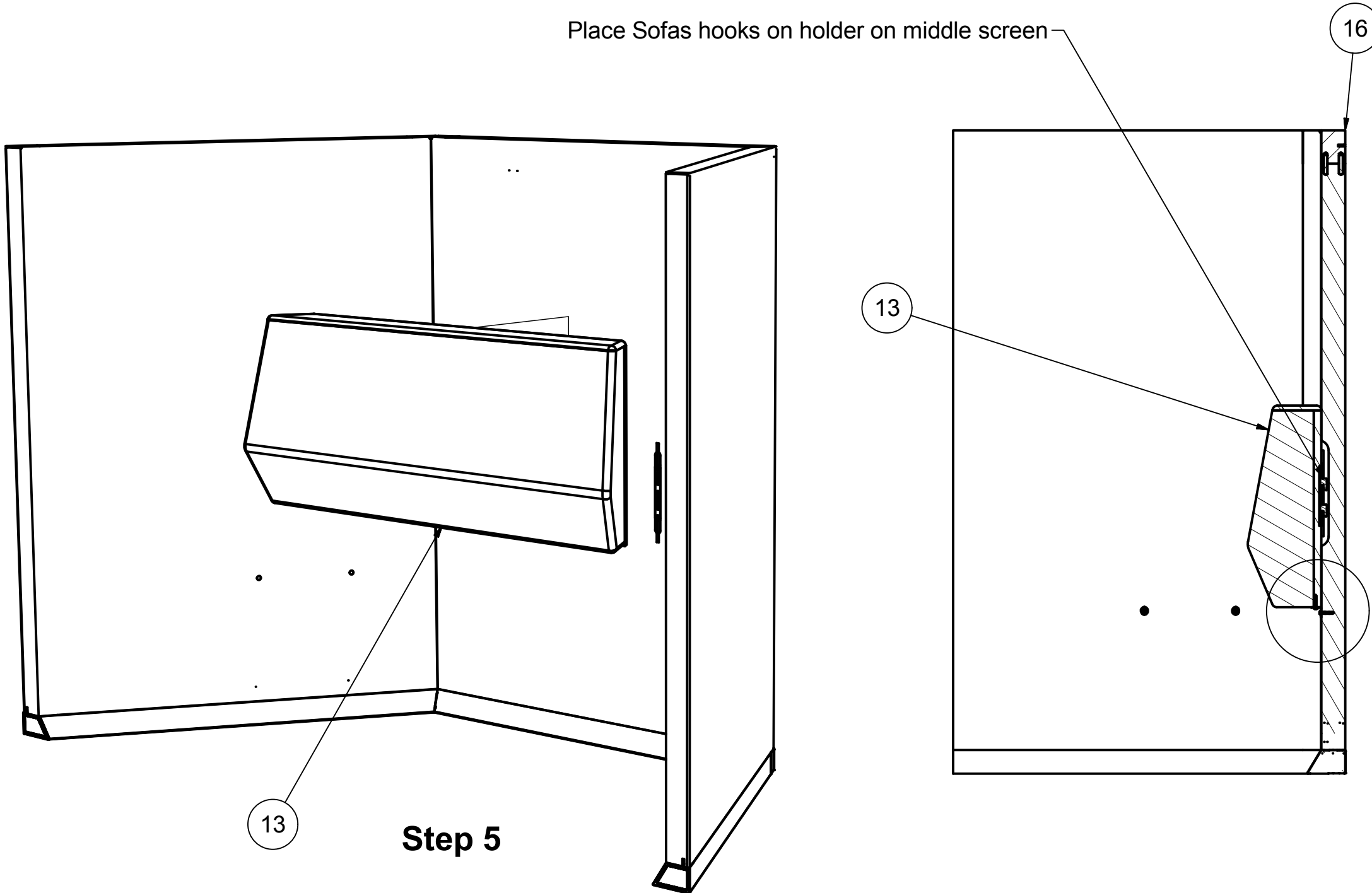
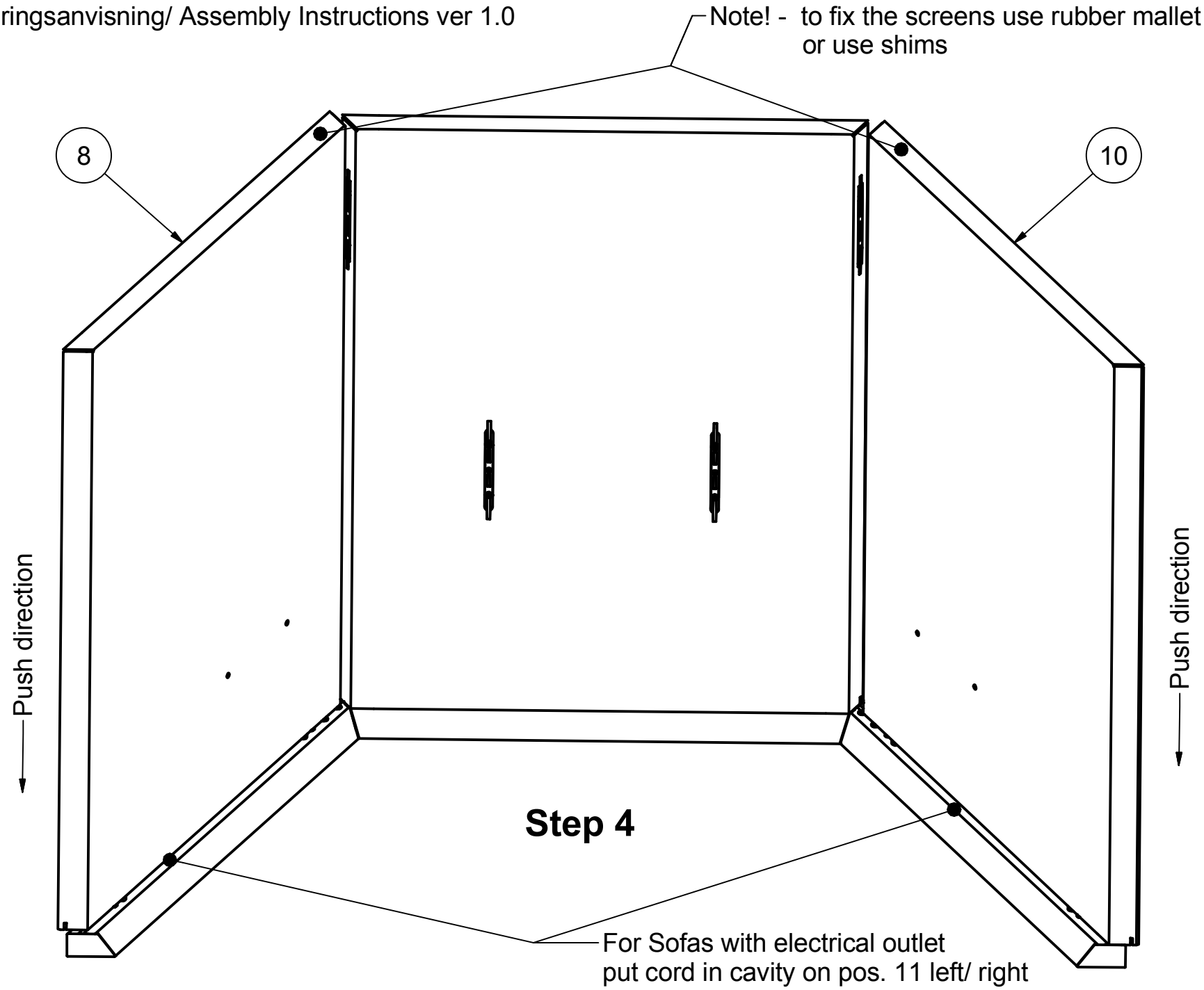

ABSTRACTA

My Hive Sofa

Monteringsanvisning/ Assembly Instructions ver 1.0

